

ACCESSORIES + NON-SYSTEM MATERIAL

Price List May 2007

RUX[®]

ALWAYS PREPARED FOR YOUR CALL . . .



Rux GmbH, with its extensive range of products and

services, is the ideal partner for today's scaffolding company. The product range is characterized by an outstanding quality, attractive prices and availability at short notice and complies with all your needs.

The non-system accessories are conceived to the latest findings and adapted to the daily needs in the scaffolding sector.

We are prepared to give you our utmost support in making your choice for the appropriate product or submit a detailed offer – also

for façade and modular scaffold-ing systems, heavy-load supports, lifts and working platforms, mobile towers and weather protection systems.

Please let us know if you should miss a scaffolding product in our brochures. We are able to provide you with almost every article at short notice.

We would like to draw your attention to our regular special offers and our stock of used material of all known scaffolding systems.

Our competent team with the well-known partners is at your service under the contact data indicated.

Yours Volker Rux



Volker Rux
Managing Director

Phone 02331 4709-100
Mobile 0151 16206500
Mail v.rux@rux.de



Marco Hiby
Sales Director

Phone 02331 4709-200
Mobile 0151 16206501
Mail hiby@rux.de



Rainer Krüger
Domestic Sales Manager

Phone 02331 4709-210
Mobile 0151 16206503
Mail krueger@rux.de



Andreas Gonschior
Purchasing manager

Phone 02331 4709-300
Mobile 0160 90141767
Mail gonschior@rux.de



Walter Hiby
Sales

Phone 02331 4709-240
Mobile 0151 16206502
Mail w.hiby@rux.de



Jörn Winkler
Representative

Phone 0441 682682
Mobile 0151 16206504
Mail joern_winkler@t-online.de



Roland Okken
Representative

Phone 030 515858-22
Mobile 0151 16158881
Mail okken@rux.de



Hans-Jörg Schmitz
Representative

Phone 02331 4709-220
Mobile 0163 3163113
Mail h.j.schmitz@rux.de



Thomas Venn
Representative

Phone 02331 4709-225
Mobile 0151 16204109
Mail venn@rux.de



Frank Wiemann
Representative

Phone 02331 4709-220
Mobile 0151 16204107
Mail wiemann@rux.de



Helmut Blauth
Representative

Mobile 0160 90142851
Mail blauth@rux.de



Bernhard Mäusel
Representative

Phone 0941 5987557
Mobile 0160 99122919
Mail bernhard-maeusel@rux.de



Andreas Hoffmann
Representative

Phone 0351 33602-65
Mobile 0151 16204108
Mail hoffmann@rux.de



Udo Lüling
Sales

Phone 02331 4709-230
Mail lueling@rux.de



Marina Calamonte
Sales

Phone 02331 4709-253
Mail calamonte@rux.de



Tanja Hiepler
Sales

Phone 02331 4709-260
Mobile 0151 16204113
Mail hiepler@rux.de



Sandra Rux
Sales

Phone 02331 4709-255
Mail s.rux@rux.de



Régis Roy
Export representative

Phone 02331 4709-255
Mobile 0151 16206506
Mail roy@rux.de



Joachim Specht (IBS)
Engineering

Phone 02355 400867
Mobile 0178 4115003
Mail ibspecht1@aol.com

If you should not reach the partner requested, please dial our service hotline: +49 2331 4709-180

TABLE OF CONTENTS

| CATEGORY | SUBJECT | PAGE |
|-----------------|---|----------------|
| 1 | Tubes and base jacks | 4 |
| 2 | Couplers | 5 - 7 |
| 3 | Castors | 8 |
| 4 | Lattice girder | 9 - 11 |
| 5 | Triangular column | 11 |
| 6 | Ladders · Accessories | 12 |
| 7 | Aluminium beam | 13 |
| 8 | Aluminium planks | 14 |
| 9 | Timber planks and steel planks | 15 - 16 |
| 10 | Ratchet spanner and work aids | 17 - 18 |
| 11 | Mounting material | 19 - 20 |
| 12 | Pallets and storage | 20 - 21 |
| 13 | Tarpaulins, nets and keder systems | 22 - 25 |
| 14 | Shrink foil | 26 |
| 15 | Work safety | 27 |
| 16 | Site safety equipment | 28 |
| 17 | Order form | 29 |
| 18 | Conditions of sale and delivery | 31 |
| 19 | How to find us | 32 |

TUBES AND BASE JACKS



Tube 1½" 3.25 mm wall thickness

Steel St 37, hot dip galvanized, dimensions as per DIN 4427. Ø 48.3 x 3.25 mm. Factory length of 6.00 m. Minimum yield point 235 Nm/m². Connection of standard couplers permitted.

| Length m | Width m | Weight approx. kg | List price | Part No. | for order volume of: Price per piece | | |
|-------------|------------|----------------------|---------------|-------------|--------------------------------------|------------------|-------------------|
| 1.00 | | 3.4 | 7.10 | 06057 | 1: 6.30 | 61: 5.50 | 244: 5.10 |
| 2.00 | | 6.8 | 13.95 | 06058 | 1: 12.55 | 61: 10.80 | 244: 9.80 |
| 3.00 | | 10.2 | 20.95 | 06056 | 1: 18.85 | 61: 15.95 | 244: 14.40 |
| 4.00 | | 13.6 | 27.90 | 06059 | 1: 25.10 | 61: 21.65 | 244: 18.55 |
| 5.00 | | 17.0 | 34.85 | 06064 | 1: 31.40 | 61: 26.65 | 244: 23.20 |
| 6.00 | | 20.4 | 39.90 | 06060 | 1: 35.90 | 61: 30.40 | 244: 27.85 |

Larger quantities upon request

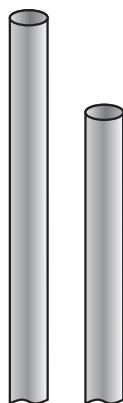

Tube 1½" 4.05 mm wall thickness. Price and delivery time on demand

Aluminium tube 1½" 4.00 mm wall thickness

Aluminium AlMgSi 1 F28, Ø 48.3 x 4.00 mm. Factory lengths of 6.00 m and 8.00 m. For connection of standard couplers for light scaffold structures.

| Length m | Width m | Weight approx. kg | List price | Part No. | for order volume of: Price per piece | | |
|-------------|------------|----------------------|---------------|-------------|--------------------------------------|------------------|-------------------|
| 6.00 | | 8.4 | 64.90 | 00959 | 1: 57.80 | 50: 52.40 | 200: 48.30 |

Other sizes and larger quantities upon request

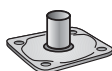

Base jack

Steel, hot dip galvanized, base plate 150 x 150 mm with spigot approx. 60 mm high, for diverting the load on the standards onto the pad.

| Length m | Width m | Weight approx. kg | List price | Part No. | for order volume of: Price per piece | | |
|-------------|------------|----------------------|---------------|-------------|--------------------------------------|------------------|--|
| | | 1.2 | 4.30 | 00378 | 1: 4.10 | 100: 3.75 | |

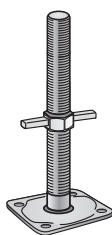

Base jack

Steel, hot dip galvanized, for heavy loads. **Load capacity: up to 50 kN**, steel with handle nut, rolled fast-run thread. Base plate 150 x 150 mm. Catch to prevent nut from being screwed off. Screw Ø 38 mm.

| Length m | Width m | Weight approx. kg | List price | Part No. | for order volume of: Price per piece | | |
|-------------|------------|----------------------|---------------|-------------|--------------------------------------|-------------------|-------------------|
| 0.30 | | 2.4 | 11.90 | 00357 | 1: 10.40 | 100: 8.20 | 250: 7.40 |
| 0.50 | | 2.9 | 13.80 | 00358 | 1: 11.90 | 100: 8.90 | 250: 8.70 |
| 0.78 | | 3.8 | 18.30 | 00360 | 1: 15.80 | 100: 12.60 | 200: 11.80 |
| 1.00 | | 4.7 | 22.90 | 00365 | 1: 19.60 | 100: 15.50 | 200: 13.90 |

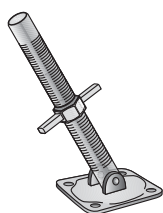

Hinged, adjustable base jack

Steel, hot dip galvanized, with tiltable base plate 150 x 150 mm. For inclined scaffolds. Additional stiffeners required at base point in the longitudinal direction. Permissible load: 25.4 kN.

| Length m | Width m | Weight approx. kg | List price | Part No. | for for order volume of: Price per piece | | |
|-------------|------------|----------------------|---------------|-------------|--|------------------|-------------------|
| 0.50 | | 3.1 | 29.60 | 00361 | 1: 24.00 | 50: 22.50 | 100: 19.80 |



Standard coupler

Steel, drop-forged, hot dip galvanized, with BB mark of conformity as per DIN 4420 and EN 74, for right-angle connection of scaffold tubes.

With collar nuts 19 or 22 mm width across the flat. Approved as single coupler for safe load of 9.1 kN or as double coupler for 15.2 kN. Nut tightening torque 50 Nm.

| | Weight approx. kg | List price | Part No. | for order volume of: Price per piece | | |
|-------|-------------------|------------|----------|--------------------------------------|------------------|-------------------|
| SW 19 | 1.6 | 4.60 | 04963 | 1: 4.10 | 250: 3.40 | 1000: 2.90 |
| SW 22 | 1.6 | 4.60 | 04962 | 1: 4.10 | 250: 3.40 | 1000: 2.90 |



Swivel coupler

Steel, drop-forged, hot dip galvanized, with B mark of conformity as per DIN 4420 and EN 74, for connection of scaffold tubes as random angles.

With collar nuts 19 or 22 mm width across the flat. Safe load 5.2 kN. Nut tightening torque 50 Nm.

| | Weight approx. kg | List price | Part No. | for order volume of: Price per piece | | |
|-------|-------------------|------------|----------|--------------------------------------|------------------|-------------------|
| SW 19 | 1.6 | 5.90 | 04960 | 1: 4.70 | 250: 3.90 | 1000: 3.50 |
| SW 22 | 1.6 | 5.90 | 04961 | 1: 4.70 | 250: 3.90 | 1000: 3.50 |

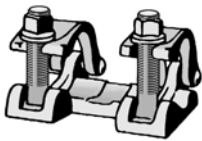

Tension coupler

Steel, drop-forged, hot dip galvanized, robust design, ribbed, with B mark of conformity as per DIN 4420 and EN 74, for tube extension in connection with a tube connector.

With collar nuts 19 or 22 mm width across the flat. Safe load 6.1 kN. Nut tightening torque 50 Nm.

| | Weight approx. kg | List price | Part No. | for order volume of: Price per piece | | |
|-------|-------------------|------------|----------|--------------------------------------|------------------|------------------|
| SW 19 | 1.6 | 6.60 | 00494 | 1: 5.50 | 100: 4.80 | 400: 4.25 |
| SW 22 | 1.6 | 6.60 | 00492 | 1: 5.50 | 100: 4.80 | 400: 4.25 |

Couplers with stamped name on it, for order volume of more than 5000 pieces of one sort, price on demand.



Tube connector

Steel, drop-forged, hot dip galvanized, for scaffold tubes \varnothing 48.3 mm for producing compression-proof butt connections, use together with tension coupler.

| | Weight approx. kg | List price | Part No. | for order volume of: Price per piece | | |
|--|-------------------|------------|----------|--------------------------------------|------------------|------------------|
| | 1.0 | 2.90 | 00377 | 1: 2.40 | 100: 2.20 | 500: 2.08 |



Half-coupler

Steel, drop-forged, hot dip galvanized, robust design, ribbed, with B mark approval as per DIN 4420 and EN 74, as weld-on coupler or for special structures with collar nuts.

Approved as single coupler for a permissible load of 9.00 kN. Nut tightening torque 50 Nm. The 16 mm \varnothing mounting hole also enables the coupler can be screwed on.

| | Weight approx. kg | List price | Part No. | for order volume of: Price per piece | | |
|-------|-------------------|------------|----------|--------------------------------------|------------------|------------------|
| SW 19 | 0.7 | 3.10 | 00497 | 1: 2.70 | 100: 2.46 | 300: 2.30 |
| SW 22 | 0.7 | 3.10 | 00495 | 1: 2.70 | 100: 2.46 | 300: 2.30 |

COUPLERS



Shore coupler

Steel, drop-forged, hot dip galvanized, half coupler with welded shore hook. Ideal for tying scaffolds at larger distances between wall and scaffold. With collar nuts of 19 or 22 mm width. Nut tightening torque 50 Nm.

| | Weight approx. kg | List price | Part No. | for order volume of: Price per piece | | |
|-------|-------------------|------------|----------|--------------------------------------|-----------------|------------------|
| SW 19 | 1.1 | 8.95 | 00444 | 1: 6.20 | 50: 5.80 | 100: 5.60 |
| SW 22 | 1.1 | 8.95 | 00445 | 1: 6.20 | 50: 5.80 | 100: 5.60 |



Carrier coupler

Steel, drop-forged, hot dip galvanized, half coupler with welded steel bracket for suspending tubes or chains on steel structures, 9 kN permissible load, to be fitted in pairs, with collar nuts of 19 or 22 mm width across the flat. Nut tightening torque 50 Nm.

| | Weight approx. kg | List price | Part No. | for order volume of: Price per piece | | |
|-------|-------------------|------------|----------|--------------------------------------|------------------|------------------|
| SW 19 | 1.1 | 9.70 | 00453 | 1: 9.20 | 100: 7.30 | 250: 6.95 |
| SW 22 | 1.1 | 9.70 | 00454 | 1: 9.20 | 100: 7.30 | 250: 6.95 |



Gravity lock coupler

Steel, drop-forged, hot dip galvanized, half coupler with collar nuts 19 or 22 mm width and welded gravity lock. Nut tightening torque 50 Nm.

| | Weight approx. kg | List price | Part No. | for order volume of: Price per piece | | |
|-------|-------------------|------------|----------|--------------------------------------|------------------|------------------|
| SW 19 | 0.8 | 7.30 | 00447 | 1: 6.25 | 100: 5.50 | 250: 4.95 |
| SW 22 | 0.8 | 7.30 | 00448 | 1: 6.25 | 100: 5.50 | 250: 4.95 |



Square timber coupler, swivable

Steel, drop-forged, hot dip galvanized, half coupler with collar nuts 19 or 22 mm width and perforated, swivable bracket for fitting timber. Nut tightening torque 50 Nm.

| | Weight approx. kg | List price | Part No. | for order volume of: Price per piece | | |
|-------|-------------------|------------|----------|--------------------------------------|------------------|-------------------|
| SW 19 | 2.0 | 15.30 | 00450 | 1: 12.90 | 50: 11.50 | 100: 11.20 |
| SW 22 | 2.0 | 15.30 | 00451 | 1: 12.90 | 50: 11.50 | 100: 11.20 |



Parallel coupler

Steel, drop-forged, hot dip galvanized. The parallel coupler serves to rigidly connect various system standards, or non-system scaffold tubes, to one another, in parallel direction taking design-related conditions into account. Axis spacing 180 mm.

| | Weight approx. kg | List price | Part No. | for order volume of: Price per piece | | |
|-------|-------------------|------------|----------|--------------------------------------|------------------|------------------|
| SW 19 | 1.9 | 15.90 | 01511 | 1: 12.90 | 50: 10.90 | 100: 9.90 |
| SW 22 | 1.9 | 15.90 | 01512 | 1: 12.90 | 50: 10.90 | 100: 9.90 |



Screw-on coupler

Steel, drop-forged, hot dip galvanized, half-coupler with collar nut 19 or 22 mm as well as welded machine bolt M 14 x 50 mm.

| | Weight approx. kg | List price | Part No. | for order volume of: Price per piece | | |
|-------|-------------------|------------|----------|--------------------------------------|-----------------|------------------|
| SW 19 | 0.7 | 7.50 | 00464 | 1: 6.50 | 50: 6.20 | 100: 6.10 |
| SW 22 | 0.7 | 7.50 | 00465 | 1: 6.50 | 50: 6.20 | 100: 6.10 |



Standard coupler with reduction piece

Steel, drop-forged, hot dip galvanized, for the connection of tubes with different outer diameters, with collar nuts.

| For tube Ø mm | | Weight approx. kg | List price | Part No. | for order volume of: Price per piece | | |
|------------------|-------|----------------------|---------------|-------------|--------------------------------------|------------------|------------------|
| 48 x 34 | SW 19 | 1.1 | 13.30 | 00106 | 1: 11.90 | 100: 9.90 | 200: 8.70 |
| 48 x 34 | SW 22 | 1.1 | 13.30 | 00117 | 1: 11.90 | 100: 9.90 | 200: 8.70 |

Delivery time and other sizes on demand



Swivel coupler with reduction piece

Steel, drop-forged, hot dip galvanized, for the connection of tubes with different outer diameters, with collar nuts.

| For tube Ø mm | | Weight approx. kg | List price | Part No. | for order volume of: Price per piece | | |
|------------------|-------|----------------------|---------------|-------------|--------------------------------------|-------------------|-------------------|
| 48 x 34 | SW 19 | 1.6 | 13.90 | 00138 | 1: 12.50 | 100: 10.40 | 200: 9.00 |
| 48 x 38 | SW 19 | 1.6 | 14.10 | 00139 | 1: 12.70 | 100: 10.60 | 200: 9.20 |
| 48 x 42 | SW 19 | 1.6 | 14.30 | 00140 | 1: 12.90 | 100: 10.70 | 200: 9.30 |
| 48 x 51 | SW 19 | 1.7 | 14.60 | 00169 | 1: 13.20 | 100: 10.95 | 200: 9.50 |
| 48 x 63 | SW 19 | 1.8 | 14.90 | 00176 | 1: 13.40 | 100: 11.20 | 200: 9.70 |
| 48 x 76 | SW 19 | 2.0 | 15.50 | 00142 | 1: 13.95 | 100: 11.60 | 200: 10.20 |

Delivery time on demand



| Length m | Width m | Weight approx. kg | List price | Part No. | for order volume of: Price per piece | | |
|-------------|------------|----------------------|---------------|-------------|---|--|--|
| | | | 1.79 | 05330 | Coupler shell galvanized | | |
| | | | 0.20 | 05331 | Rivet | | |
| | | | 1.58 | 05329 | Centre piece, crude with hole | | |
| | | | 1.58 | 05335 | Centre piece, crude without hole | | |



Collar nut

Steel St 37, drop-forged, electro-galvanized, 19 or 22 mm width, tensile strength category 5 in accordance with ISO 898 T. 2.

| | Weight approx. kg | List price | Part No. | for order volume of: Price per piece | | |
|-------|----------------------|---------------|-------------|--------------------------------------|------------------|-------------------|
| SW 19 | 0.03 | 0.18 | 00430 | 200: 0.16 | 600: 0.14 | 2000: 0.13 |
| SW 22 | 0.04 | 0.20 | 00431 | 200: 0.18 | 600: 0.16 | 2000: 0.15 |



Hammer head bolt

Steel St 37, drop-forged, electro-galvanized, M 14 thread, shaft length approx. 68 mm. Strength 5.8 in according with ISO 898 T. 1.

| Length m | Width m | Weight approx. kg | List price | Part No. | for order volume of: Price per piece | | |
|-------------|------------|----------------------|---------------|-------------|--------------------------------------|------------------|-------------------|
| | | 0.09 | 0.30 | 00433 | 100: 0.26 | 600: 0.22 | 2000: 0.20 |

CASTORS

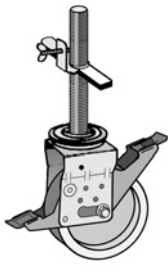

Castor

Reinforced, galvanized steel plate housing, ball bearings in slewing ring, sliding bearing in the hub, nylon wheel, with locking lever, **no overhang** when castor is locked.

With additional foot lever for releasing the brake and 500 mm screw.

- ① **Castor 3.0 kN**, wheel Ø 150 mm, height: 245 mm plus screw 500 mm.
- ② **Castor 5.0 kN**, wheel Ø 200 mm, height: 295 mm plus screw 500 mm.
- ③ **Castor 10.0 kN**, wheel Ø 200 mm, height: 295 mm plus screw 500 mm.

| Length m | Width m | Weight approx. kg | List price | Part No. | for order volume of: Price per piece | | |
|-------------|------------|----------------------|---------------|-------------|--------------------------------------|-----------------|------------------|
| | | ① 3.0 | 47.40 | 02449 | 1: 42.00 | 8: 36.50 | 24: 32.80 |
| | | ② 5.0 | 72.00 | 05506 | 1: 59.40 | 8: 52.00 | 24: 49.40 |
| | | ③ 6.8 | 80.20 | 05507 | 1: 68.80 | 8: 60.50 | 24: 56.80 |

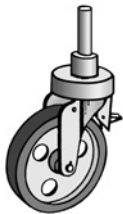

Steering castor 12.5 kN (1250 kp) permissible load

high quality steel housing and precision slewing ring in the fork head.

Vulcanite wheel 250 x 60 mm with ball bearing and wheel lock and cast steel spigot for coupler connection to prevent castor falling out. Fitting height: 320 mm.

| Length m | Width m | Weight approx. kg | List price | Part No. | for order volume of: Price per piece | | |
|-------------|------------|----------------------|---------------|-------------|--------------------------------------|------------------|-------------------|
| | | 14.9 | 198.00 | 00384 | 1: 169.00 | 8: 158.00 | 24: 152.50 |



Castor 7.5 kN (750 kp) permissible load

fixed castor for bridge or hall construction, 250 x 50 mm, ball bearing, steel plate housing with stop and retainer to prevent castor from falling out. With spigot 200 x 38 mm, Fitting height: 260 mm
Clear width 19 mm.

| Length m | Width m | Weight approx. kg | List price | Part No. | for order volume of: Price per piece | | |
|-------------|------------|----------------------|---------------|-------------|--------------------------------------|-----------------|------------------|
| | | 6.6 | 59.70 | 00392 | 1: 56.50 | 8: 52.00 | 24: 48.30 |

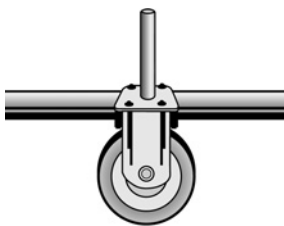

Flange wheel with two coupler connections

- ① **with nylon wheel 15 kN (1500 kp) permissible load**
- ② **with steel wheel 30 kN (3000 kp) permissible load**

The castor housing is equipped with two additional half-couplers to create a sturdy chassis for special scaffolding designs. Clear width 19 mm.

| Length m | Width m | Weight approx. kg | List price | Part No. | for order volume of: Price per piece | | |
|-------------|------------|----------------------|---------------|-------------|--------------------------------------|------------------|-------------------|
| | | ① 12.8 | 230.00 | 04676 | 1: 210.00 | 4: 192.00 | 12: 172.50 |
| | | ② 25.4 | 365.00 | 04688 | 1: 335.00 | 4: 315.00 | 12: 295.00 |

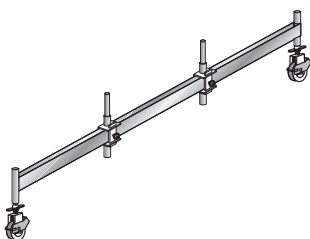

Universal mobile base unit for all scaffold systems of Ø 48.3 mm without castors

Two adjustable connectors for universal use in conjunction with Mobilo 800/1400/ Super 65/100 and other systems.

| Length m | Width m | Weight approx. kg | List price | Part No. | for order volume of: Price per piece | | |
|-------------|------------|----------------------|---------------|-------------|--------------------------------------|------------------|------------------|
| 2.00 | | 24.5 | 200.60 | 05505 | 1: 176.00 | 4: 159.00 | 8: 148.00 |

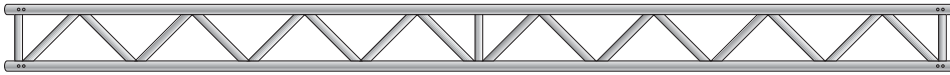

Aluminium lattice girder, approved by the national authorities

Aluminium tube 48.3 mm \emptyset , wall thickness 4 mm, parallel lattice girder, 450 mm wide. Used as bridge girder for special structures. With high load capacity, or for large spans. Load capacity dependent on span width as per special load table. Connection with standard couplers permitted. Lattice girders fitted parallel are braced with scaffold tubes and couplers on the top chord, loads to be proved.

| Length m | Width m | Weight approx. kg | List price | Part No. | for order volume of: Price per piece | | |
|-------------|------------|----------------------|---------------|-------------|--------------------------------------|-------------------|-------------------|
| 3.20 | 0.45 | 13.0 | 145.00 | 00982 | 1: 122.00 | 10: 113.00 | 20: 99.80 |
| 4.20 | 0.45 | 17.0 | 188.00 | 00983 | 1: 156.00 | 10: 142.00 | 20: 132.50 |
| 5.20 | 0.45 | 21.0 | 219.00 | 00984 | 1: 179.00 | 10: 168.00 | 20: 155.00 |
| 6.20 | 0.45 | 25.0 | 259.50 | 00985 | 1: 215.00 | 10: 196.50 | 20: 180.50 |
| 8.20 | 0.45 | 33.0 | 345.00 | 00986 | 1: 279.00 | 10: 258.00 | 20: 239.00 |

Steel lattice girder (standard design), approved by the national authorities

Steel tube St 37-2 with increased yield point, $\beta_s = 320 \text{ N/mm}^2$, hot dip galvanized, 48.3 mm \emptyset .

Wall thickness 3.25 mm, parallel chord lattice girder, 450 mm wide. Used as a bridge and load bearing element for special structures. Load capacity dependant on span as per special load table.

| Length m | Width m | Weight approx. kg | List price | Part No. | for order volume of: Price per piece | | |
|-------------|------------|----------------------|---------------|-------------|--------------------------------------|-------------------|-------------------|
| 3.10 | 0.45 | 30.0 | 109.00 | 00632 | 1: 90.50 | 10: 79.60 | 20: 71.80 |
| 4.10 | 0.45 | 37.0 | 152.00 | 00633 | 1: 120.00 | 10: 110.50 | 20: 98.80 |
| 5.10 | 0.45 | 48.0 | 192.00 | 00634 | 1: 155.50 | 10: 136.50 | 20: 125.60 |
| 6.10 | 0.45 | 61.0 | 218.00 | 00635 | 1: 181.00 | 10: 154.50 | 20: 142.50 |
| 7.10 | 0.45 | 70.0 | 258.00 | 00636 | 1: 218.00 | 10: 179.80 | 20: 166.40 |
| 7.60 | 0.45 | 75.0 | 276.00 | 00637 | 1: 238.00 | 10: 196.50 | 20: 178.70 |

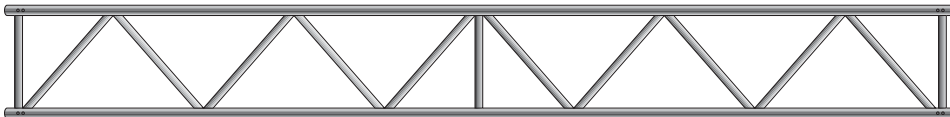

Heavy-duty lattice girder, approved by the national authorities

Steel tube St 37 with increased yield point, $\beta_s = 320 \text{ N/mm}^2$, hot dip galvanized, 48.3 mm \emptyset .

Wall thickness 3.25 mm, parallel chord lattice girder, 750 mm wide. Suitable as a bridge for special structures with high load capacity or for larger span widths.

| Length m | Width m | Weight approx. kg | List price | Part No. | for order volume of: Price per piece | | |
|-------------|------------|----------------------|---------------|-------------|--------------------------------------|-------------------|-------------------|
| 2.00 | 0.75 | 27.00 | 138.50 | 00781 | 1: 130.00 | 10: 122.50 | 20: 114.00 |
| 3.00 | 0.75 | 31.00 | 185.90 | 00782 | 1: 174.50 | 10: 164.00 | 20: 156.00 |
| 4.00 | 0.75 | 42.00 | 234.00 | 00783 | 1: 219.00 | 10: 205.50 | 20: 195.00 |
| 5.00 | 0.75 | 50.00 | 297.00 | 00784 | 1: 278.00 | 10: 259.00 | 20: 238.00 |
| 6.00 | 0.75 | 60.00 | 334.50 | 00785 | 1: 314.50 | 10: 294.80 | 20: 268.00 |
| 7.00 | 0.75 | 69.00 | 393.00 | 00786 | 1: 369.60 | 10: 345.00 | 20: 318.00 |
| 7.50 | 0.75 | 75.00 | 398.50 | 00787 | 1: 375.00 | 10: 348.00 | 20: 328.00 |

Heavy-duty lattice girder, approved by the national authorities

Steel tube St 52, hot dip galvanized, 48.3 mm \emptyset . Wall thickness 3.60 mm, parallel lattice girder, 1050 mm wide.

| Length m | Width m | Weight approx. kg | List price | Part No. | for order volume of: Price per piece | | |
|-------------|------------|----------------------|---------------|-------------|--------------------------------------|-------------------|-------------------|
| 1.63 | 1.05 | 33.00 | 169.00 | 01492 | 1: 159.00 | 10: 153.00 | 20: 148.00 |
| 2.26 | 1.05 | 35.00 | 202.00 | 01494 | 1: 187.00 | 10: 176.00 | 20: 171.00 |
| 2.87 | 1.05 | 51.00 | 262.00 | 01495 | 1: 258.00 | 10: 242.00 | 20: 239.00 |
| 4.12 | 1.05 | 62.00 | 354.00 | 01497 | 1: 341.00 | 10: 313.00 | 20: 309.00 |
| 5.36 | 1.05 | 83.00 | 445.00 | 01499 | 1: 437.00 | 10: 394.00 | 20: 391.00 |

LATTICE GIRDER

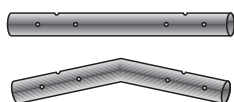

Tube connector for lattice girders

Steel St 37-2, hot dip galvanized, including 4 machine screws M 12 x 60. For continuous extension of the girders. Suitable for standard design girders with 3.25 mm wall thickness.

| Height m | Width m | Weight approx. kg | List price | Part No. | for order volume of: Price per piece | |
|--------------|------------|----------------------|---------------|-------------|--------------------------------------|------------------|
| straight | | 1.8 | 11.90 | 00615 | 1: 10.50 | 20: 9.65 |
| curved short | | 2.0 | 23.50 | 00616 | 1: 21.00 | 20: 19.50 |
| curved long | | 2.4 | 25.90 | 00617 | 1: 23.50 | 20: 21.20 |



Tube connector for aluminium lattice girder 4.00 m wall thickness

Steel St 37-2, hot dip galvanized, including 4 machine screws M 12 x 60.

| Height m | Width m | Weight approx. kg | List price | Part No. | for order volume of: Price per piece | |
|-------------|------------|----------------------|---------------|-------------|--------------------------------------|------------------|
| | | 1.8 | 16.30 | 00618 | 1: 14.90 | 20: 13.20 |



Tube connector for heavy-duty lattice girder 3.60 mm wall thickness

Steel St 52-3, hot dip galvanized, including 4 machine screws M 12 x 60.

| Height m | Width m | Weight approx. kg | List price | Part No. | for order volume of: Price per piece | |
|-------------|------------|----------------------|---------------|-------------|--------------------------------------|------------------|
| | | 2.5 | 22.20 | 00614 | 1: 21.60 | 20: 19.40 |

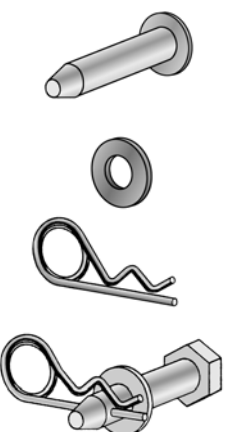

Insert pin

galvanized. The insert pin for boltless connection of lattice girders replaces the usual bolts and thus greatly reduces erection times.

The high-tensile pins can be used for all RUX lattice girders.

| Length m | Width m | Weight approx. kg | List price | Part No. | for order volume of: Price per piece | |
|-------------|------------|----------------------|---------------|-------------|--------------------------------------|------------------|
| Pin | | | 1.46 | 00813 | 1: 1.40 | 100: 1.19 |
| Washer | | | 0.10 | 00814 | 1: 0.08 | 100: 0.06 |
| Clip | | | 0.54 | 00815 | 1: 0.48 | 100: 0.42 |
| Complete | | | 2.10 | 04662 | 1: 1.96 | 100: 1.67 |



Hexagon steel screw M 12 x 60, 8.8 incl. Nut

for suspended scaffolds.

| Length m | Width m | Weight approx. kg | List price | Part No. | for order volume of: Price per piece | |
|-------------|------------|----------------------|---------------|-------------|--------------------------------------|------------------|
| | | | 0.56 | 00812 | 1: 0.52 | 100: 0.42 |

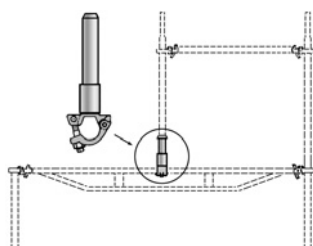

Tube connector with half-coupler

Steel, hot dip galvanized, screwed onto lattice girders or tubes. For fitting standards or tubes.

| Length m | Width m | Weight approx. kg | List price | Part No. | for order volume of: Price per piece | |
|-------------|------------|----------------------|---------------|-------------|--------------------------------------|------------------|
| SW 19 | | 1.8 | 18.20 | 00470 | 1: 15.90 | 20: 13.80 |
| SW 22 | | 1.8 | 18.20 | 00471 | 1: 15.90 | 20: 13.80 |

LATTICE GIRDER · TRIANGULAR COLUMN



Adapter for vertical frames on lattice girder bridges

Steel, hot dip galvanized. The use of this adapter eliminates the time consuming and complicated fitting of the vertical frames to non-system lattice girder bridges with an overall height of 45 cm. The self-locking adapters are placed on the lattice girders and adjusted by the jack screw. The free-standing frames are immediately secured against tilting. Suitable for all normal scaffold systems and lattice girders.

| Length m | Width m | Weight approx. kg | List price | Part No. | for order volume of: Price per piece | |
|-------------|------------|----------------------|---------------|-------------|--------------------------------------|------------------|
| | | 5.9 | 43.70 | 00638 | 1: 39.00 | 12: 32.80 |

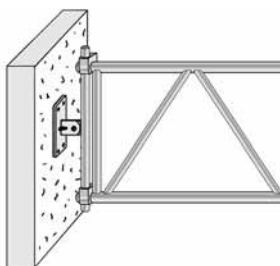

Universal wall connector plate for lattice girders, with 20 mm drill-hole

Steel, hot dip galvanized. Universally suitable for all commercial types of lattice girder, produces a firm, rigid connection between structure and lattice girder.

The creation of an hinged joint means that the use of force is avoided.

| Length m | Width m | Weight approx. kg | List price | Part No. | Price/each | |
|-------------|------------|----------------------|---------------|-------------|------------------|-------------------|
| 1.20 | | 15.6 | 136.00 | 00639 | 1: 126.00 | 12: 118.50 |

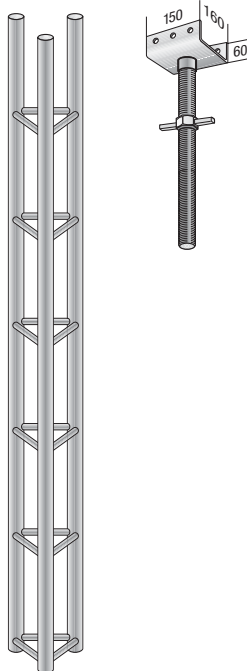

U-head jack

Steel, hot dip galvanized, with handle nut, rolled fast-run thread, tiltable by 5°.

Head plate 160 x 150 x 60 mm. Catch to prevent handle nut screwing off.

| Length m | Width m | Weight approx. kg | List price | Part No. | for order volume of: Price per piece | |
|-------------|------------|----------------------|---------------|-------------|--------------------------------------|------------------|
| 0.55 | | 5.8 | 49.60 | 00363 | 1: 44.00 | 30: 39.90 |

Triangular column

Steel tube, 48.3 mm Ø, hot dip galvanized,
3 scaffold tubes linked together in triangular form.
High load capacity. (Leg length 125 mm)

| Permissible load when loaded at the centre: | hm | P safe (kN) |
|--|-----|-------------------|
| When using the full load capacity, the columns must be articulately mounted at the top and bottom. | 3.0 | 100 = (10.000 kp) |
| | 4.0 | 90 |
| | 5.0 | 80 |
| | 6.0 | 70 |

| Length m | Width m | Weight approx. kg | List price | Part No. | for order volume of: Price per piece | |
|-------------|------------|----------------------|---------------|-------------|--------------------------------------|-------------------|
| 3.00 | | 35.0 | 152.50 | 00793 | 1: 136.00 | 10: 113.80 |
| 4.00 | | 47.0 | 199.60 | 00795 | 1: 169.50 | 10: 142.00 |
| 5.00 | | 65.0 | 253.00 | 00796 | 1: 219.20 | 10: 187.00 |
| 6.00 | | 70.0 | 298.50 | 00797 | 1: 257.50 | 10: 218.50 |

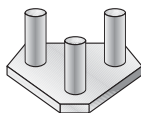

Triangular base plate

for triangular column, steel, hot dip galvanized, plate 30 x 30 cm,
with 3 welded spigots for diverting the load into the ground.

| Length m | Width m | Weight approx. kg | List price | Part No. | for order volume of: Price per piece | |
|-------------|------------|----------------------|---------------|-------------|--------------------------------------|------------------|
| 0.30 | 0.30 | 6.3 | 34.20 | 00788 | 1: 31.50 | 10: 27.60 |

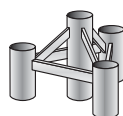

End adapter for triangular columns

Steel, hot dip galvanized, for central load distribution into the column.

Base jacks or head jacks can be used. Height 15 cm.

| Length m | Width m | Weight approx. kg | List price | Part No. | for order volume of: Price per piece | |
|-------------|------------|----------------------|---------------|-------------|--------------------------------------|------------------|
| 0.17 | 0.17 | 2.6 | 43.50 | 00789 | 1: 38.50 | 10: 34.30 |

LADDERS · ACCESSORIES

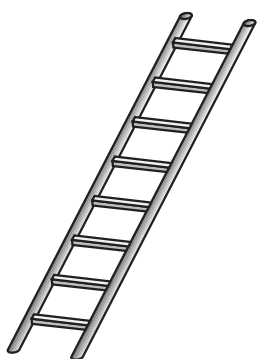

Steel tube ladder

This extremely sturdy ladder is very popular in the trade for use under tough conditions. The stringers are 48.3 mm steel tube ensuring standard coupler connection. The ladders can be extended using the standard tube connectors and tension couplers.

| Length m | Width m | Weight approx. kg | List price | Part No. | for order volume of: Price per piece | |
|-------------|------------|----------------------|---------------|-------------|--------------------------------------|-------------------|
| 2.00 | 0.45 | 17.0 | 108.00 | 00350 | 1: 98.20 | 10: 89.60 |
| 3.00 | 0.45 | 25.0 | 135.60 | 00351 | 1: 123.30 | 10: 113.20 |
| 4.00 | 0.45 | 33.0 | 163.00 | 00352 | 1: 148.50 | 10: 136.20 |
| 5.00 | 0.45 | 42.0 | 198.00 | 00353 | 1: 179.80 | 10: 164.80 |
| 6.00 | 0.45 | 51.0 | 229.80 | 00354 | 1: 209.20 | 10: 189.90 |

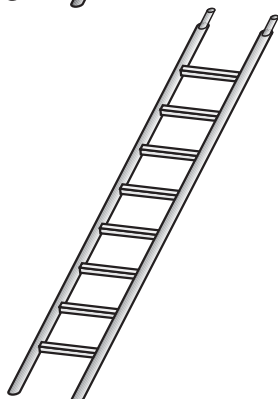

Aluminium ladder

With solidly riveted tube connectors, suitable for all types of scaffolds including ladder scaffolds. TÜV approved. The stringers are 48.3 mm aluminium tube ensuring standard coupler connection. Rung spacing 28 cm, width 47 cm. **Price including tube connector and plastic foot.**

| Length m | Width m | Weight approx. kg | List price | Part No. | for order volume of: Price per piece | | |
|-------------|------------|----------------------|---------------|-------------|--------------------------------------|-------------------|-------------------|
| 2.00 | 0.47 | 6.0 | 83.50 | 00965 | 1: 70.80 | 10: 66.80 | 25: 61.80 |
| 3.00 | 0.47 | 9.0 | 113.50 | 00966 | 1: 96.50 | 10: 90.50 | 25: 84.30 |
| 4.00 | 0.47 | 11.0 | 143.00 | 00967 | 1: 122.00 | 10: 114.00 | 25: 106.20 |
| 5.00 | 0.47 | 14.0 | 182.60 | 00968 | 1: 155.00 | 10: 146.00 | 25: 135.30 |
| 6.00 | 0.47 | 16.0 | 209.50 | 00969 | 1: 178.00 | 10: 167.60 | 25: 155.20 |

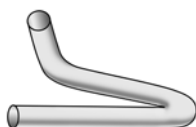

Drop pin

For securing ladders and scaffold frames with drilled tube connectors.

| Length m | Width m | Weight approx. kg | List price | Part No. | for order volume of: Price per piece | | |
|-------------|------------|----------------------|---------------|-------------|--------------------------------------|------------------|------------------|
| | | 0.1 | 0.98 | 00396 | 1: 0.94 | 100: 0.86 | 200: 0.79 |



Spacer tube

Steel, hot dip galvanized, for compensating large unevenness in the terrain. To be used together with plank bearer and base jack. Range of adjustment 10 x 0.10 m = 1.00 m.

| Length m | Width m | Weight approx. kg | List price | Part No. | for order volume of: Price per piece | |
|-------------|------------|----------------------|---------------|-------------|--------------------------------------|------------------|
| 1.80 | | 6.4 | 36.80 | 00668 | 1: 30.90 | 10: 27.60 |

Spare parts for spacer tube

| Length m | Width m | Weight approx. kg | List price | Part No. | for order volume of: Price per piece | | |
|----------------|------------|----------------------|---------------|-------------|--------------------------------------|-----------------|------------------|
| Ferrule | | 0.135 | 2.80 | 00568 | 1: 2.60 | 10: 2.40 | 100: 2.10 |
| Pin | | 0.178 | 2.10 | 00569 | 1: 1.95 | 10: 1.70 | 100: 1.55 |



Scaffold cord

Made of polypropylene mixed with sisal, with an eyelet at one end.

| Length m | Breaking resistance kg | List price | Part No. | for order volume of: Price per piece | |
|-------------|---------------------------|---------------|-------------|--------------------------------------|------------------|
| 1.50 | 480 | 0.66 | 01337 | 1: 0.62 | 200: 0.55 |
| 2.00 | 480 | 0.74 | 01341 | 1: 0.68 | 200: 0.58 |
| 2.50 | 480 | 0.84 | 01345 | 1: 0.78 | 200: 0.66 |
| 3.00 | 480 | 0.91 | 01349 | 1: 0.85 | 200: 0.75 |
| 1.80 | polypropylene 500 | 0.69 | 01359 | 1: 0.62 | 200: 0.56 |

Aluminium beam I 160

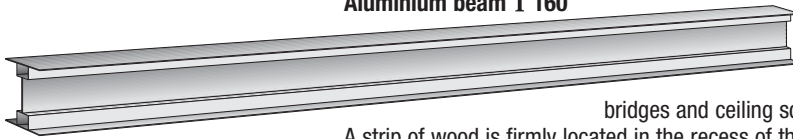

This scaffolding element can be easily placed on any support capable of bearing loads. The excellent alloyage: Al Zn 4.5 Mg 1 F 35 makes it extremely robust and provides for high load capacity. Particularly suitable for large area bridges and ceiling scaffolds. The beams can be covered with standard battens.

A strip of wood is firmly located in the recess of the top flange enabling the battens to be bolted in position on ceiling scaffolds to prevent movement and stiffening the beam.

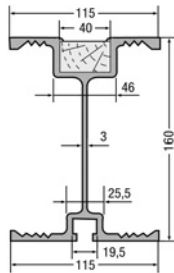

Load capacities as single beam I 160

| Single bay beam evenly distributed load | | | | | | | | | |
|---|-------|-------|-------|-------|-------|-------|------|------|--|
| Span L (m) | 2.00 | 3.00 | 4.00 | 5.00 | 6.00 | 7.00 | 7.50 | 8.00 | |
| Safe evenly dis. load Z (kN/m) | 19.70 | 8.75 | 4.90 | 3.10 | 2.15 | 1.55 | 1.30 | 1.17 | |
| Safe total load Q (kN) | 39.35 | 26.15 | 19.50 | 15.50 | 12.80 | 10.85 | 9.75 | 9.35 | |

| Single bay beam point load at bay centre | | | | | | | | | |
|--|-------|-------|------|------|------|------|------|------|--|
| Span L (m) | 2.00 | 3.00 | 4.00 | 5.00 | 6.00 | 7.00 | 7.50 | 8.00 | |
| Safe single load P (kN) | 19.70 | 13.10 | 9.75 | 7.75 | 6.40 | 5.45 | 5.00 | 4.70 | |

| Length m | Width m | Weight approx. kg | List price | Part No. | Price/m = 33.18 € | | |
|----------|---------|-------------------|------------|----------|-------------------|------------|------------|
| 6.40 | 0.12 | 33.9 | 351.00 | 01004 | 1: 315.80 | 10: 309.00 | 20: 293.00 |
| 8.00 | 0.12 | 42.4 | 439.00 | 01009 | 1: 395.00 | 10: 388.00 | 20: 366.40 |
| 11.90 | 0.12 | 47.7 | 652.80 | 01017 | 1: 587.50 | 10: 566.50 | 20: 544.80 |

Larger quantities upon request.



Beam clamp

robust, drop-forged design, hot dip galvanized, SW 24, maximum clamping width 40 mm.

| Length m | Width m | Weight approx. kg | List price | Part No. | for order volume of: Price per piece | |
|----------|---------|-------------------|------------|----------|--------------------------------------|-----------|
| 0.03 | 0.09 | 1.2 | 17.20 | 01021 | 1: 16.40 | 20: 15.55 |

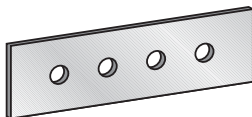

Butt strap, complete

zinc plated, for extending 2 beams. Consisting of 2 straps and 4 bolts (M 16 x 100).

| Length m | Width m | Weight approx. kg | List price | Part No. | for order volume of: Price/Set | |
|----------|---------|-------------------|------------|----------|--------------------------------|-----------|
| 0.60 | 0.15 | 11.4 | 54.80 | 01020 | 1: 52.50 | 10: 49.90 |

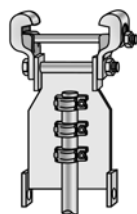

Holding claw

For connecting scaffold tubes to steel I beams up to a width of 300 mm. Area of application: suspended scaffolds underneath bridges, and steel structures.

| Length m | Width m | Weight approx. kg | List price | Part No. | for order volume of: Price per piece | | |
|----------|---------|-------------------|------------|----------|--------------------------------------|------------|------------|
| 0.50 | 0.25 | 13.8 | 144.00 | 00730 | 1: 139.00 | 10: 135.00 | 20: 131.00 |

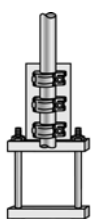

Adapter coupler for aluminium beam

For connecting scaffold tubes to aluminium girders from I 160 and on.

| Length m | Width m | Weight approx. kg | List price | Part No. | for order volume of: Price per piece | | |
|----------|---------|-------------------|------------|----------|--------------------------------------|-----------|-----------|
| 0.50 | 0.25 | 9.0 | 96.60 | 00731 | 1: 93.00 | 10: 89.50 | 20: 87.90 |

ALUMINIUM PLANKS

Aluminium span bridge plank made up of rectangular box sections

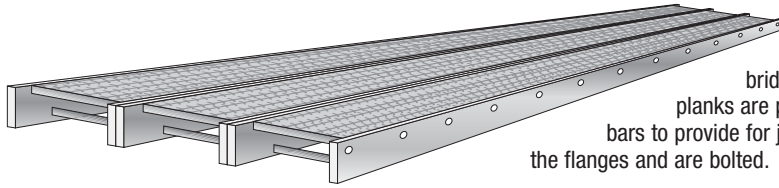

Using the aluminium plank will save you time and material. Its large span makes the plank ideal for ceiling scaffolds and bridges. A bearing surface of 30 to 50 cm is required. If several planks are placed alongside one another, they are connected by Dywidag bars to provide for joint load bearing. The bars are inserted in the side apertures of the flanges and are bolted.

– GS approved –
for use on safety scaffolds
in accordance with DIN 4420



The live load is to be applied in accordance with scaffold category 2 at 1.50 kN/m². The aluminium plank provides an economical structural alternative for safety and working scaffold.

It goes without saying that the aluminium span bridge has the GS mark of approval for use as part of a working and safety scaffold system.

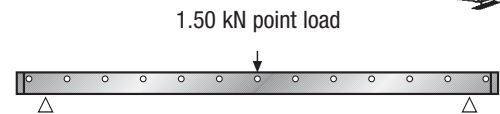
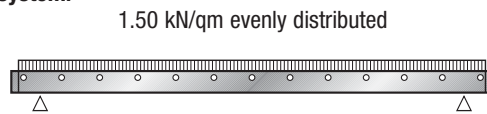
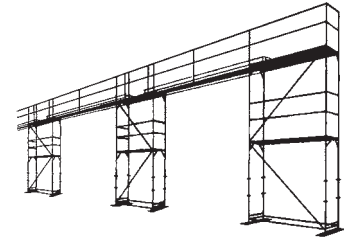

| Length m | Width m | Weight approx. kg | List price | Part No. | for order volume of: Price per piece | |
|-------------|------------|----------------------|---------------|-------------|--------------------------------------|-------------------|
| 4.00 | 0.57 | 23.0 | 390.00 | 00987 | 1: 372.00 | 10: 330.80 |
| 5.20 | 0.57 | 30.0 | 498.00 | 00988 | 1: 448.00 | 10: 415.00 |
| 6.00 | 0.57 | 35.0 | 558.00 | 00989 | 1: 496.00 | 10: 465.50 |
| 8.00 | 0.57 | 59.0 | 890.00 | 00990 | 1: 797.50 | 10: 743.00 |
| 10.20 | 0.57 | 72.0 | 1138.00 | 00991 | 1: 1024.00 | 10: 950.50 |



Railing holder for aluminium planks

for fitting random system railing posts.
Ensures a simple mounting of the 3-part rails.

| Length m | Width m | Weight approx. kg | List price | Part No. | Price/each | |
|--------------|------------|----------------------|---------------|-------------|-----------------|------------------|
| for 1 plank | | 2.8 | 27.50 | 00404 | 1: 24.90 | 10: 22.40 |
| for 2 planks | | 3.4 | 38.70 | 00407 | 1: 34.50 | 10: 31.40 |



Railing holder opposite hand for aluminium planks

for fitting random system railing posts.
The opposite hand holder ensures a trouble-free fitting of the double-side 3-part guard rails.

| Length m | Width m | Weight approx. kg | List price | Part No. | Price/each | |
|-------------|------------|----------------------|---------------|-------------|-----------------|------------------|
| | | 1.4 | 19.80 | 00408 | 1: 18.10 | 10: 16.40 |



Tilt lock

for aluminium planks, steel, drop-forged, hot dip galvanized, half coupler with collar nut 19 or 22 mm width across the flat and welded bracket to prevent tilting of the aluminium planks.

| Length m | Width m | Weight approx. kg | List price | Part No. | Price/each | |
|-------------|------------|----------------------|---------------|-------------|-----------------|------------------|
| SW 19 | | 1.0 | 15.60 | 00401 | 1: 15.40 | 10: 13.80 |
| SW 22 | | 1.0 | 15.60 | 00402 | 1: 15.40 | 10: 13.80 |

TIMBER PLANKS AND STEEL PLANKS

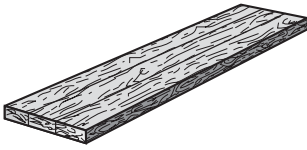

Special bonded plank, red impregnated (other colours upon request)

The non-system safety plank for the use on all modular and tube/coupler scaffolds. Risk of breakage significantly reduced through computer-controlled laser testing of the individual timber sections. Testing in accordance with DIN 4074 in grade S10. The environmental friendly impregnation ensures improved protection against rot and thus a greater durability.

| Length mm | Width mm | Thickness mm | Weight approx. kg | List price | Part No. | for order volume of: Price per piece | | |
|-----------|----------|--------------|-------------------|------------|----------|--------------------------------------|------------------|-------------------|
| 3000 | 240 | 45 | 18.0 | 25.60 | 01100 | 1: 23.00 | 80: 20.57 | 240: 18.79 |
| 3500 | 240 | 45 | 21.0 | 29.86 | 01101 | 1: 26.84 | 80: 24.00 | 240: 21.92 |
| 4000 | 240 | 45 | 24.0 | 34.13 | 01102 | 1: 30.67 | 80: 27.43 | 240: 25.06 |

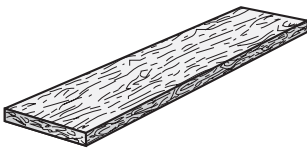

Timber plank

of the well-known good quality. Tested in accordance with DIN 4074 in grade S10.

Safe spans in m as per table below in accordance with DIN 4420.

| Batten or plank width cm | Scaffold Class | Batten or plank thickness in cm | | | | |
|--------------------------|----------------|---------------------------------|------|------|------|------|
| | | 3.0 | 3.5 | 4.0 | 4.5 | 5.0 |
| 20 | 1, 2, 3 | 1.25 | 1.50 | 1.75 | 2.25 | 2.50 |
| 24 and 28 | | 1.25 | 1.75 | 2.25 | 2.50 | 2.75 |
| 20 | 4 | 1.25 | 1.50 | 1.75 | 2.25 | 2.50 |
| 24 and 28 | | 1.25 | 1.75 | 2.00 | 2.25 | 2.50 |
| 20, 24, 28 | 5 | 1.25 | 1.25 | 1.50 | 1.75 | 2.00 |
| 20, 24, 28 | 6 | 1.00 | 1.25 | 1.25 | 1.50 | 1.75 |

| Length mm | Width mm | Thickness mm | Weight approx. kg | List price | Part No. | for order volume of: Price per piece | | |
|-----------|----------|--------------|-------------------|------------|----------|--------------------------------------|------------------|-------------------|
| 1000 | 240 | 45 | 6.0 | 5.18 | 01075 | 1: 4.43 | 80: 4.10 | 240: 3.67 |
| 1500 | 240 | 45 | 9.0 | 7.78 | 01078 | 1: 6.64 | 80: 6.16 | 240: 5.51 |
| 2000 | 240 | 45 | 12.0 | 10.37 | 01080 | 1: 8.86 | 80: 8.21 | 240: 7.34 |
| 2500 | 240 | 45 | 15.0 | 12.96 | 01082 | 1: 11.07 | 80: 10.26 | 240: 9.18 |
| 3000 | 240 | 45 | 18.0 | 15.55 | 01083 | 1: 13.28 | 80: 12.31 | 240: 11.02 |
| 3500 | 240 | 45 | 21.0 | 18.14 | 01086 | 1: 15.50 | 80: 14.36 | 240: 12.85 |
| 4000 | 240 | 45 | 24.0 | 20.74 | 01090 | 1: 17.71 | 80: 16.42 | 240: 14.69 |
| 4500 | 240 | 45 | 27.0 | 23.33 | 01094 | 1: 19.93 | 80: 18.47 | 240: 16.52 |
| 5000 | 240 | 45 | 30.0 | 25.92 | 01095 | 1: 22.14 | 80: 20.52 | 240: 18.36 |
| 1000 | 280 | 45 | 7.0 | 6.05 | 01106 | 1: 5.17 | 80: 4.79 | 240: 4.28 |
| 1500 | 280 | 45 | 10.5 | 9.07 | 01107 | 1: 7.75 | 80: 7.18 | 240: 6.43 |
| 2000 | 280 | 45 | 14.0 | 12.10 | 01109 | 1: 10.33 | 80: 9.58 | 240: 8.57 |
| 2500 | 280 | 45 | 17.5 | 15.12 | 01111 | 1: 12.92 | 80: 11.97 | 240: 10.71 |
| 3000 | 280 | 45 | 21.0 | 18.14 | 01112 | 1: 15.50 | 80: 14.36 | 240: 12.85 |
| 3500 | 280 | 45 | 24.5 | 21.17 | 01114 | 1: 18.08 | 80: 16.76 | 240: 14.99 |
| 4000 | 280 | 45 | 28.0 | 24.19 | 01115 | 1: 20.66 | 80: 19.15 | 240: 17.14 |
| 4500 | 280 | 45 | 31.5 | 27.22 | 01116 | 1: 23.25 | 80: 21.55 | 240: 19.28 |
| 5000 | 280 | 45 | 35.0 | 30.24 | 01117 | 1: 25.83 | 80: 23.94 | 240: 21.42 |

Special prices for larger quantities upon request!

Surcharge for hooped planks, per plank

- ① edged and fitted with corrugated iron hoops including stamped name.
- ② fitted with corrugated hoops.

| Length mm | Width mm | Thickness mm | Weight approx. kg | List price | Part No. | Price/each |
|-----------|----------|--------------|-------------------|------------|----------|-------------|
| | | | | | ① 01071 | 2.90 |
| | | | | | ② 01069 | 1.80 |

TIMBER PLANKS AND STEEL PLANKS

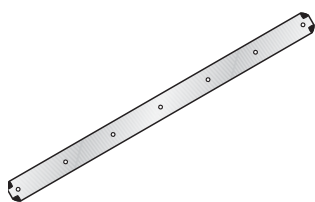

Iron hoop for timber planks
galvanized, with folded corners.

| Length mm | Width mm | Weight kg p. 100 | List price | Part No. | for order volume of: Price per piece | |
|--------------|-------------|---------------------|---------------|-------------|--------------------------------------|-------------------|
| 500 | 30 | 11.0 | 0.44 | 00757 | 100: 0,41 | 1000: 0,39 |
| 600 | 30 | 12.0 | 0.48 | 00759 | 100: 0,44 | 1000: 0,42 |

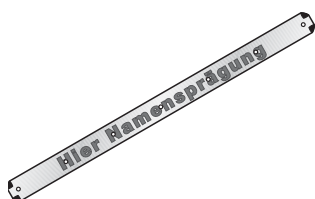

Iron hoop for timber planks
galvanized, with folded corners and embossed name.

| Length mm | Width mm | Weight kg p. 100 | List price | Part No. | for order volume of: Price per piece | |
|--------------|-------------|---------------------|---------------|-------------|--------------------------------------|-------------------|
| 500 | 30 | 11.0 | 0.50 | 00758 | 100: 0,47 | 1000: 0,44 |
| 600 | 30 | 12.0 | 0.56 | 00760 | 100: 0,52 | 1000: 0,49 |

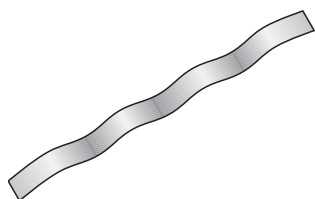

Corrugated iron hoop
bright, for driving into the ends of boards, price per roll = approx. 50 m.

| Length mm | Width mm | Weight approx. kg | List price | Part No. | for order volume of: Price per piece | |
|--------------|-------------|----------------------|---------------|-------------|--------------------------------------|-----------------|
| 18 | 1 | 6.8 | 26.40 | 00761 | 1: 25,30 | 4: 23,20 |

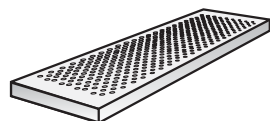

Steel plank, non-system
Steel, hot dip galvanized, perforated.
Height: 45 mm

| Length m | Width m | Weight approx. kg | List price | Part No. | for order volume of: Price per piece | |
|-------------|------------|----------------------|---------------|-------------|--------------------------------------|-------------------|
| 1.00 | 0.30 | 6.9 | 34.20 | 05612 | 50: 28.90 | 200: 24.90 |
| 1.50 | 0.30 | 9.3 | 39.90 | 05613 | 50: 35.70 | 200: 32.80 |
| 2.00 | 0.30 | 11.7 | 45.80 | 05614 | 50: 41.20 | 200: 38.20 |
| 2.50 | 0.30 | 13.9 | 53.40 | 05617 | 50: 47.90 | 200: 44.60 |
| 1.00 | 0.26 | 6.7 | 34.20 | 05608N | 50: 28.90 | 200: 24.90 |
| 1.50 | 0.26 | 9.1 | 39.90 | 05609N | 50: 35.70 | 200: 32.80 |
| 2.00 | 0.26 | 11.4 | 45.80 | 05610N | 50: 41.20 | 200: 38.20 |
| 2.50 | 0.26 | 13.6 | 53.40 | 05611N | 50: 47.90 | 200: 44.60 |

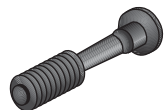

Safety plug, plastic
anti-skidding device for non-system steel planks.

| Length mm | Width mm | Weight approx. kg | List price | Part No. | for order volume of: Price per piece | |
|--------------|-------------|----------------------|---------------|-------------|--------------------------------------|------------------|
| 70 | | 0.01 | 0.20 | 05615 | 100: 0.18 | 500: 0.16 |



Toe board clamp
Solid steel wire, hot dip galvanized, for fixing the toe-board in tube coupler scaffolds as well as for fixing non-system wooden planks in safety scaffolds.

| Length mm | Width mm | Weight approx. kg | List price | Part No. | for order volume of: Price per piece | |
|--------------|-------------|----------------------|---------------|-------------|--------------------------------------|------------------|
| | | 0.1 | 1.86 | 00376 | 100: 1.68 | 500: 1.49 |

RATCHET SPANNER AND WORK AIDS



Ratchet spanner (identical with Mannesmann, made in Germany)
special design with steel striker head and aluminium handle, rivetted, extremely robust, heavy-duty design with single nut, length: 31 cm.

| Length mm | Width mm | Weight approx. kg | List price | Part No. | for order volume of: Price per piece | | |
|-----------|----------|-------------------|------------|----------|--------------------------------------|-----------------|------------------|
| SW 19 | | 0.8 | 86.00 | 00321 | 1: 76.80 | 5: 72.80 | 10: 68.50 |
| SW 22 | | 0.8 | 86.00 | 00322 | 1: 76.80 | 5: 72.80 | 10: 68.50 |

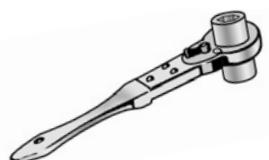

Double ratchet spanner (identical with Mannesmann, made in Germany)
as above but with double nut.

| Length mm | Width mm | Weight approx. kg | List price | Part No. | for order volume of: Price per piece | | |
|-----------|----------|-------------------|------------|----------|--------------------------------------|-----------------|------------------|
| SW 19+22 | | 0.9 | 92.50 | 00326 | 1: 79,60 | 5: 76,40 | 10: 74,20 |
| SW 22+24 | | 0.9 | 92.50 | 00328 | 1: 79,60 | 5: 76,40 | 10: 74,20 |



Double ratchet spanner ROBUST
Extra long and sturdy lever arm for easy operation, high-grade steel, 5 year guarantee when used properly! Length: 36 cm, with double nut.

| Length mm | Width mm | Weight approx. kg | List price | Part No. | for order volume of: Price per piece | | |
|-----------|----------|-------------------|------------|----------|--------------------------------------|-----------------|------------------|
| SW 19+22 | | 0.9 | 49.00 | 05218 | 1: 45.00 | 5: 42.50 | 10: 39.90 |



Double ratchet spanner LIGHT
Simple and handy for universal use, length 31 cm, with double nut.

| Length mm | Width mm | Weight approx. kg | List price | Part No. | for order volume of: Price per piece | | |
|-----------|----------|-------------------|------------|----------|--------------------------------------|-----------------|------------------|
| SW 19+22 | | 0.4 | 47.00 | 04657 | 1: 33.70 | 5: 31.60 | 10: 29.90 |

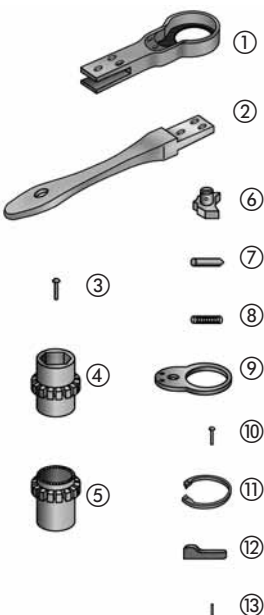

Spare parts for ratchet spanner (identical with Mannesmann, made in Germany)

| | Part No. | Price/each |
|--|----------|--------------|
| ① Housing..... | 00344 | 51.13 |
| ② Aluminium handle | 00345 | 15.34 |
| ③ Half-round rivet for handle 5 x 25 DIN 660 | 00340 | 0.51 |
| ④ Double ratchet wheel W 19 + 22 | 00329 | 40.39 |
| ⑤ Ratchet wheel W 19..... | 00332 | 30.68 |
| ⑤ Ratchet wheel W 22..... | 00333 | 30.68 |
| ⑥ Ratchet piece..... | 00335 | 15.34 |
| ⑦ Ratchet pin..... | 00337 | 1.02 |
| ⑧ Compression spring for ratchet pin | 00342 | 0.51 |
| ⑨ Cover | 00336 | 5.11 |
| ⑩ Half-round rivet for cover 2,5 x 20 DIN 660 | 00341 | 0.51 |
| ⑪ Circlip for cover | 00339 | 1.02 |
| ⑫ Switching lever | 00338 | 2.05 |
| ⑬ Pin for switching lever 2 x 12 mm..... | 00343 | 0.51 |

Special prices for larger quantities upon request!

RATCHET SPANNER AND WORK AIDS

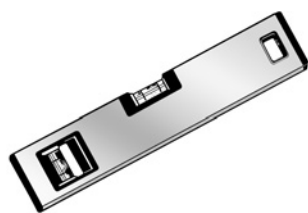

Spirit level with magnet

Aluminium. Easy to handle, extremely robust and shock-proof. A precision instrument, not only when used in the normal position but also for overhead work. With hole for snap hook.

| Length m | Width m | Weight approx. kg | List price | Part No. | for order volume of: Price per piece | | |
|-------------|------------|----------------------|---------------|-------------|--------------------------------------|------------------|------------------|
| 0.25 | | 0.2 | 23.52 | 00868 | 1: 19.50 | 10: 17.60 | 20: 16.90 |



STABILA spirit level with magnet

Aluminium. Easy to handle, extremely robust and shock-proof. A precision instrument, not only when used in the normal position but also for overhead work. With hole for snap hook.

| Length m | Width m | Weight approx. kg | List price | Part No. | for order volume of: Price per piece | | |
|-------------|------------|----------------------|---------------|-------------|--------------------------------------|------------------|------------------|
| 0.25 | | 0.2 | 34.80 | 00867 | 1: 31.30 | 10: 28.90 | 20: 26.40 |

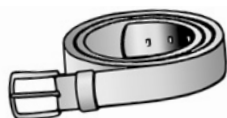

Ratchet spanner belt leather

| Length m | Width m | Weight approx. kg | List price | Part No. | for order volume of: Price per piece | | |
|-------------|------------|----------------------|---------------|-------------|--------------------------------------|-----------------|-----------------|
| 1.20 | | 0.1 | 9.90 | 00346 | 1: 9.70 | 10: 9.30 | 20: 9.10 |



Ratchet spanner holster leather

| Length mm | Width mm | Weight approx. kg | List price | Part No. | for order volume of: Price per piece | | |
|--------------|-------------|----------------------|---------------|-------------|--------------------------------------|-----------------|--|
| 70 | | | 4.80 | 00347 | 1: 4.40 | 10: 4.00 | |



Snap hook

material Ø 11 mm, steel, zinc plated.

| Length mm | Width mm | Weight kg p. 100 | List price | Part No. | for order volume of: Price per piece | | |
|--------------|-------------|---------------------|---------------|-------------|--------------------------------------|-----------------|-----------------|
| 120 | | 18.0 | 1.76 | 00735 | 1: 1.76 | 10: 1.60 | 20: 1.50 |

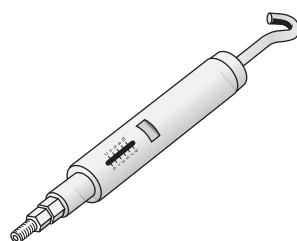

Tie tester

For checking the capacity of scaffold ties. Using the ratchet to adjust the pull-out force, the tensile strength of the tie can be determined exactly. The pull-out breaking cone is not adversely affected by the testing operations.

Measuring range 0-10.00 kN, for ring bolts up to 20 cm in length.

| Length m | Width m | Weight kg | List price | Part No. | for order volume of: Price per piece | | |
|-------------|------------|--------------|---------------|-------------|--------------------------------------|--|--|
| | | 1.8 | 290.00 | 03242 | 1: 275.00 | | |

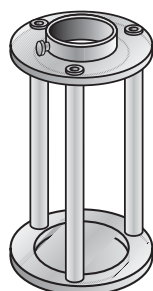

Support Cylinder for the tie tester.

| Length m | Width m | Weight kg | List price | Part No. | for order volume of: Price per piece | | |
|-------------|------------|--------------|---------------|-------------|--------------------------------------|--|--|
| | | 1.8 | 30.00 | 03244 | 1: 28.50 | | |



Altimeter Leica DISTO

Measuring range from 0 – 200 m with a precision of ± 3 mm. Up to 10.000 readings per set of batteries. Optimal range-finder for the scaffolding sector.

| Length m | Width m | Weight approx. kg | List price | Part No. | for order volume of: Price per piece | |
|-------------|------------|----------------------|---------------|-------------|--------------------------------------|------------------|
| | | | 369.00 | 05295 | 1: 358.00 | 3: 348.50 |

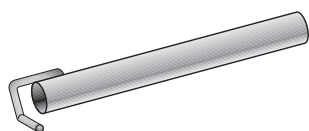

Steel shore tube

Steel tube, hot dip galvanized, for compression and yield-proof tying of the scaffold. To be fitted with standard couplers.

| Length m | Width m | Weight approx. kg | List price | Part No. | Pack/ Qty | for order volume of: Price per piece | |
|-------------|------------|----------------------|---------------|-------------|--------------|--------------------------------------|-------------------|
| 0.30 | | 1.4 | 7.80 | 00367 | | 1: 6.50 | 100: 5.70 |
| 0.40 | | 1.8 | 8.50 | 00368 | | 1: 7.40 | 100: 6.40 |
| 0.60 | | 2.5 | 10.10 | 00369 | | 1: 9.10 | 100: 7.60 |
| 1.00 | | 4.0 | 12.80 | 00370 | | 1: 11.00 | 100: 9.60 |
| 1.40 | | 5.4 | 15.10 | 00372 | | 1: 13.60 | 100: 11.30 |



Eye screw

With welded eye, galvanized, with fitting mark, suitable for 14 mm rawl plugs.

8 size and 10 size ring bolts upon request.

| Length mm | Width mm | Weight approx. kg | List price | Part No. | Pack/ Qty | for order volume of: Price per piece | | |
|--------------|-------------|----------------------|---------------|-------------|--------------|--------------------------------------|------------------|-------------------|
| 90 | 12 | 0.155 | 0.60 | 00290 | 150 | 1: 0.50 | 600: 0.46 | 2400: 0.42 |
| 120 | 12 | 0.176 | 0.64 | 00291 | 100 | 1: 0.52 | 600: 0.49 | 2400: 0.46 |
| 160 | 12 | 0.210 | 0.73 | 00292 | 100 | 1: 0.60 | 600: 0.56 | 2400: 0.52 |
| 190 | 12 | 0.237 | 0.80 | 00293 | 100 | 1: 0.63 | 600: 0.61 | 2400: 0.57 |
| 230 | 12 | 0.269 | 0.90 | 00294 | 100 | 1: 0.72 | 600: 0.68 | 2400: 0.63 |
| 300 | 12 | 0.330 | 1.10 | 00295 | 50 | 1: 0.90 | 300: 0.82 | 1200: 0.78 |
| 350 | 12 | 0.369 | 1.24 | 00296 | 25 | 1: 0.99 | 300: 0.93 | 1200: 0.90 |



Cap

for rawl plugs 14 mm

| Length mm | Width mm | Weight kg p. 100 | List price | Part No. | Pack/ Qty | for order volume of: Price per piece | | |
|--------------|-------------|---------------------|---------------|-------------|--------------|--------------------------------------|-------------------|-------------------|
| 40 | 29 | | 0.08 | 01179 | 100 | 100: 0.07 | 1000: 0.06 | white transparent |
| 50 | 25 | | 0.08 | 01199 | 100 | 100: 0.07 | 1000: 0.06 | white transparent |
| 80 | 29 | | 0.25 | 01212 | 100 | 100: 0.18 | 1000: 0.14 | white transparent |
| 120 | 30 | | 0.35 | 01201 | 100 | 100: 0.27 | 1000: 0.19 | white transparent |

Further colours and dimensions on request.



Cap

for rawl plugs 14 mm

| Length mm | Width mm | Weight kg p. 100 | List price | Part No. | Pack/ Qty | for order volume of: Price per piece | | |
|--------------|-------------|---------------------|---------------|-------------|--------------|--------------------------------------|-------------------|-------------------|
| 40 | Lid-Ø 28 | 0.186 | 0.06 | 01178 | 100 | 100: 0.05 | 1000: 0.04 | white transparent |
| 40 | 28 | 0.186 | 0.08 | 01194 | 100 | 100: 0.06 | 1000: 0.05 | black |
| 40 | 28 | 0.186 | 0.08 | 01180 | 100 | 100: 0.06 | 1000: 0.05 | grey |

Further colours and dimensions on request.

MOUNTING MATERIAL, PALLETS AND STORAGE



Nylon rawl plug

| Length mm | Width mm | Weight kg p. 250 | List price | Part No. | Pack/ Qty | for order volume of: Price per piece | | |
|-----------|----------|------------------|------------|----------|-----------|--------------------------------------|-------------------|-------------------|
| 70 | 14 | 1.4 | 0.07 | 01226 | 250 | 100: 0.06 | 1000: 0.05 | 5000: 0.04 |
| 100 | 14 | 2.5 | 0.19 | 05237 | 100 | 100: 0.14 | 1000: 0.12 | 5000: 0.10 |
| 135 | 14 | 2.5 | 0.29 | 05238 | 100 | 100: 0.22 | 1000: 0.18 | 5000: 0.15 |
| 185 | 14 | 2.5 | 0.39 | 05239 | 100 | 100: 0.30 | 1000: 0.25 | 5000: 0.20 |

Other sizes upon request

Multi-dowel

for nearly all walls, even hollow.

| Length mm | Width mm | Weight kg p. 250 | List price | Part No. | Pack/ Qty | for order volume of: Price per piece | | |
|-----------|----------|------------------|------------|----------|-----------|--------------------------------------|-------------------|-------------------|
| 75 | 14 | 2.5 | 0.09 | 01233 | 100 | 100: 0.08 | 1000: 0.07 | 5000: 0.06 |

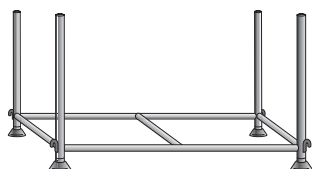

Stacking Pallet

Hot dip galvanized, particularly robust design, for formwork and scaffolding materials, maintenance-free. Convenient for storage and transportation, steel, with crane lugs. Permissible load capacity: 1.5 t. max. 5 pallets stacked one on top of the other, also available in other sizes upon request.

| Length m | Width m | Weight approx. kg | List price | Part No. | for order volume of: Price per piece | | |
|----------|---------|-------------------|------------|----------|--------------------------------------|-------------------|-------------------|
| 1.30 | 0.70 | 34.0 | 139.00 | 03165 | 1: 129.00 | 10: 114.30 | 30: 105.70 |

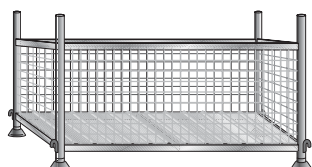

Wire Mesh Box Pallet

Hot dip galvanized, can be combined with the stacking pallet, machine width 50 x 50 x 4 mm, with crimped sheet steel base (1.5 mm thick) for small scaffolding components. Permissible load capacity: 1.5 t. max. 5 pallets stacked one on top of the other.

| Length m | Width m | Weight approx. kg | List price | Part No. | for order volume of: Price per piece | | |
|----------|---------|-------------------|------------|----------|--------------------------------------|------------------|-------------------|
| 1.30 | 0.70 | 65.0 | 365.00 | 03178 | 1: 345.00 | 5: 299.00 | 10: 283.00 |

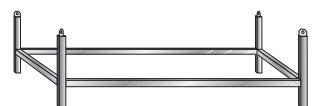

Pallet for long-length components

Steel, hot dip galvanized. Specially designed for transportation and storage of tubes, guard rails etc. The pallet provides for optimum utilisation of the truck loading space. Length: 1.50 m. Permissible load capacity: 1.0 t. 6 pallets stacked one on top of the other.

| Width m | Height m | Weight approx. kg | List price | Part No. | for order volume of: Price per piece | | |
|---------|----------|-------------------|------------|----------|--------------------------------------|-------------------|-------------------|
| 0.60 | 0.40 | 17.4 | 127.00 | 03172 | 1: 121.00 | 10: 115.00 | 20: 108.00 |
| 0.80 | 0.60 | 28.0 | 142.90 | 03176 | 1: 135.00 | 10: 128.40 | 20: 121.70 |

We will be pleased to find special solutions for your individual storing problems!

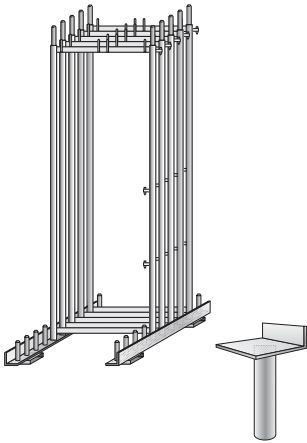

Stacker grid for all scaffolding systems

Steel, hot dip galvanized. Accommodates 20 vertical frames and provides for orderly transportation and storage.

Suitable for all vertical frames with a tube dia. of 48.3 mm.

Suitable for crane and forklift truck. Two pieces required.

| Length m | Width m | Weight approx. kg | List price | Part No. | for order volume of: Price per piece | | |
|-------------|------------|----------------------|---------------|-------------|--------------------------------------|------------------|-------------------|
| 1.57 | 0.10 | 16.8 | 109.70 | 01533 | 1: 102.00 | 20: 95.60 | 100: 89.80 |

Slip-on adapter

Steel, hot dip galvanized, slipped on the four corners onto the tube connectors of the vertical frames when using stacker grids and enables 2 and 3 stacks to be placed one on top of the other.

Four pieces required.

| Length m | Width m | Weight approx. kg | List price | Part No. | for order volume of: Price per piece | | |
|-------------|------------|----------------------|---------------|-------------|--------------------------------------|-----------------|------------------|
| | | 1.5 | 9.80 | 01534 | 4: 9.20 | 40: 8.70 | 200: 8.20 |

We will be pleased to find special solutions for your individual storing problems!

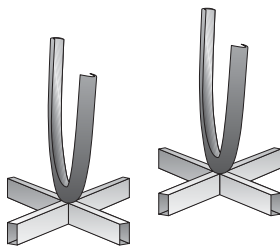

Bundling pallet with cross base

Steel, hot dip galvanized; for orderly bundling of tubes (e.g. guard rails, diagonal braces); use in pairs.

| Length m | Width m | Weight kg | Price/ each | Part No. |
|-------------|------------|--------------|----------------|-------------|
| | | 9.4 | 49.00 | 05280 |

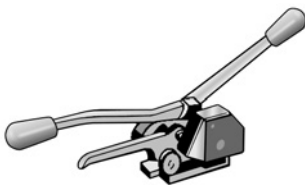

Steel strip shearing machine

for band with a width of 12.7, 16 and 19 mm. This handy piece of equipment has the advantage that no sleeves are required for fastening the ends of the strip together. Creates heavy-duty fastenings that are protected against accidental opening (80–85% as firm as the strip itself).

| Length m | Width m | Weight kg | Price/ each | Part No. |
|-------------|------------|--------------|----------------|-------------|
| | | 4.9 | 764.50 | 03158 |

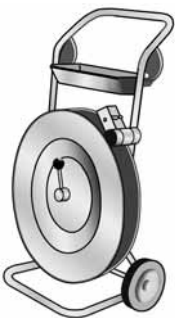

Decoiling trolley with storage box

Strip-steel decoiler with a bobbin for widths of 9.5 – 19 mm.

| Length m | Width m | Weight kg | Price/ each | Part No. |
|-------------|------------|--------------|----------------|-------------|
| | | 31.0 | 369.00 | 03161 |



Steel coil for packing

Steel strip 16 x 0.5 mm (1 coil approx. 42 kg and approx. 700 m)

| Length m | Width m | Weight kg | List price | Part No. | for order volume of: Price per piece | | |
|-------------|------------|--------------|---------------|-------------|--------------------------------------|-----------------|-----------------|
| | | 42.0 | 82.00 | 03162 | 1: 77.60 | 3: 72.00 | 6: 69.40 |

TARPAULINS, NETS AND KEDER SYSTEMS

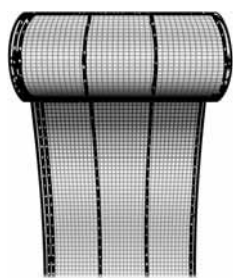

Tarpaulin mesh fabric 200

mesh fabric coated on both sides with welded eyelet tapes for fastening to the scaffold. Extremely robust and tear-resistant, white transparent.

| Length m | Width m | Weight approx. kg | List price | Part No. | for order volume of: Price per piece | | |
|-------------|------------|----------------------|---------------|-------------|--|------------------|------------------|
| 20.00 | 2.70 | 200 g/m ² | 67.64 | 04917 | 1: 48.06 | 24: 42.66 | 48: 39.96 |
| 20.00 | 3.20 | 200 g/m ² | 80.17 | 04918 | 1: 56.96 | 21: 50.56 | 42: 47.36 |
| | | | | | corresponds to price of/m ² : | | |
| | | | | | 0.89 | 0.79 | 0.74 |

Tarpaulin small band fabric 160 (not illustrated)

Double eyelets every 50 cm, polyethelene, white transparent.

| Length m | Width m | Weight approx. kg | List price | Part No. | for order volume of: Price per piece | | |
|-------------|------------|----------------------|---------------|-------------|--|------------------|------------------|
| 20.00 | 2.60 | 160 g/m ² | 39.80 | 04564 | 2: 33.80 | 20: 30.70 | 36: 29.50 |
| 20.00 | 3.10 | 160 g/m ² | 47.60 | 04565 | 2: 40.30 | 20: 36.60 | 30: 35.20 |
| | | | | | corresponds to price of/m ² : | | |
| | | | | | 0.65 | 0.59 | 0.56 |

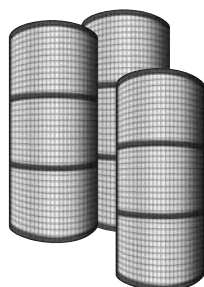

Scaffolding net 50

Monofilament HDPE, 50 g/m², fabric, UV stabilised, tear resistant, allows wind and light to penetrate, trouble-free fitting ensured through reinforced edges with button hole band. A robust quality net for the scaffolder needing that little bit extra.

| Length m | Width m | Colour | List price | Part No. | for order volume of: Price per piece | | |
|-------------|------------|--------|---------------|-------------|--|------------------|------------------|
| 20.00 | 2.57 | green | 27.60 | 01244 | 4: 24.50 | 20: 22.00 | 72: 19.50 |
| 20.00 | 3.07 | green | 32.40 | 01247 | 4: 29.40 | 20: 26.40 | 60: 23.40 |
| | | | | | corresponds to price of/m ² : | | |
| | | | | | 0.49 | 0.44 | 0.39 |

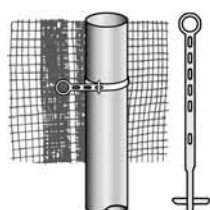

DELTA toggle strap

Provides for quick connection of the DELTA tarpaulins and nets to the scaffold. Suitable for steel and timber scaffolds.

| Length m | Width m | Weight approx. kg | List price | Part No. | for order volume of: Price per piece | | |
|-------------|------------|----------------------|---------------|-------------|--------------------------------------|------------------|------------------|
| | | | 0.49 | 01255 | 1: 0.49 | 100: 0.45 | 500: 0.39 |



Expendable fastener, simple

Colour: natural

| Length mm | Width mm | Weight approx. kg | List price | Part No. | for order volume of: Price | | |
|--------------|-------------|----------------------|---------------|-------------|----------------------------|-------------------|---------------------|
| 300 | 4.8 | 0.22 (per 100) | 0.04 | 01259 | 100: 0.04 | 2000: 0.03 | 10000: 0.025 |



Expendable fastener, reinforced

Colour: natural

| Length m | Width m | Weight approx. kg | List price | Part No. | for order volume of: Price | | |
|-------------|------------|----------------------|---------------|-------------|----------------------------|-------------------|--------------------|
| 340 | 7.6 | 0.42 (per 100) | 0.08 | 01258 | 100: 0.08 | 2000: 0.06 | 10000: 0.05 |

TARPAULINS, NETS AND KEDER SYSTEMS

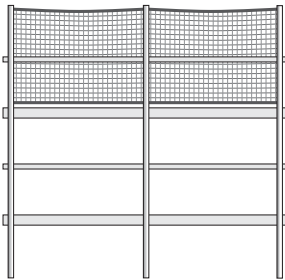

Net for roof safety barriers acc. to DIN 4420 Pkt. 8.1.2

Lateral net made of 4.50 mm Nylon cord, **mash width 100 mm.**

Nylon cord 12 mm-Ø Nylon around the edges.

The quick, simple way to create a secure safety barrier on steel and ladder scaffolds.

| Length m | Width m | Weight g/m ² | List price | Part No. | for order volume of: Price per piece | | |
|-------------|------------|----------------------------|---------------|-------------|--|------------------|------------------|
| 10.00 | 2.00 | 300 | 84.87 | 01319 | 1: 64.00 | 10: 59.60 | 35: 55.20 |
| 5.00 | 2.00 | 300 | 42.44 | 01317 | 1: 32.00 | 10: 29.80 | 35: 27.60 |
| | | | | | corresponds to price of/m ² : | | |
| | | | | | 1: 3.20 | 10: 2.98 | 35: 2.76 |

Other nets, e.g. safety nets for protection of individuals, upon request



Quick-action belt fastener

German utility patent for quick assembly of side protective nets consisting of a 25 mm wide strap, with a brass buckle. Fastening intervals: 1.00 m.

| Length m | Width m | Weight approx. kg | List price | Part No. | for order volume of: Price per piece | | |
|-------------|------------|----------------------|---------------|-------------|--------------------------------------|------------------|-------------------|
| 0.60 | | | 1.40 | 01325 | 1: 1.30 | 100: 1.02 | 1000: 0.87 |

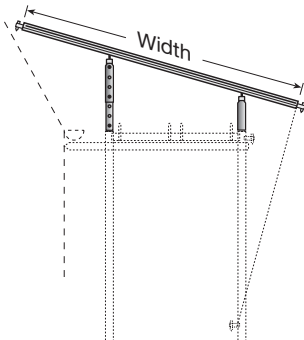

Weather protection system bearer with telescopic steel tube on one side

with infinitely variable extension tubes, fitting all scaffolding systems and widths.

Brilliantly simple mounting. The optimal rain protection for all scaffoldings.

| Length m | Width m | Weight approx. kg | List price | Part No. | for order volume of: Price per piece | | |
|-------------|------------|----------------------|---------------|-------------|--------------------------------------|------------------|------------------|
| | 1.80 | 4.0 | 102.90 | 05508 | 1: 89.00 | 10: 81.00 | 20: 77.20 |

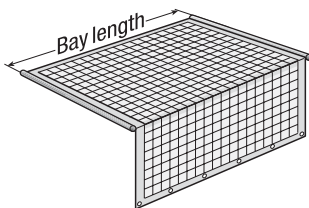

Keder tarpaulin for weather protection system bearer

Reinforced execution for heavy duty.

| Bay length m | Width m | Weight g/m ² | List price | Part No. | for order volume of: Price per piece | | |
|-----------------|------------|----------------------------|---------------|-------------|--------------------------------------|-------------------|-------------------|
| 1.50 | 2.60 | 300 | 129.80 | 05618 | 1: 116.80 | 10: 99.80 | 20: 92.80 |
| 2.00 | 2.60 | 300 | 146.90 | 05619 | 1: 132.50 | 10: 117.50 | 20: 107.20 |
| 2.50 | 2.60 | 300 | 164.10 | 05620 | 1: 147.60 | 10: 131.20 | 20: 119.70 |
| 3.00 | 2.60 | 300 | 172.00 | 05621 | 1: 154.80 | 10: 137.50 | 20: 125.50 |



TARPAULINS, NETS AND KEDER SYSTEMS

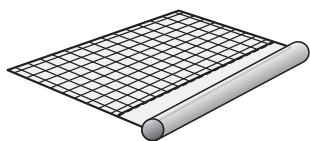

Mesh reinforced Keder tarpaulin

Technical data:

Material: PVC - extra strong, transparent with white mesh reinforcement, UV stabilised.
 Tear resistance: longitudinal 895 N, cross 850 N.
 Stretch: longitudinal 15 – 20%, cross 15 – 20%.
 Continued tearing force: longitudinal 215 N, cross 215 N.
 Keder strength: above 3,500 N.
 Temperature resistance: - 40 to + 80° C.

| Length m | Width m | Weight g/m ² | List price | Part No. | for order volume of: Price per piece | |
|-------------|-------------|----------------------------|---------------|-------------|--------------------------------------|-------------------|
| 4.10 | 1.50 | 340 | 102.50 | 01417 | 5: 95.90 | 20: 92.50 |
| 6.10 | 1.50 | 340 | 129.80 | 01418 | 5: 119.80 | 20: 115.60 |
| 8.10 | 1.50 | 340 | 153.70 | 01419 | 5: 143.70 | 20: 138.60 |
| 10.10 | 1.50 | 340 | 178.23 | 01420 | 5: 166.80 | 20: 160.90 |
| 12.10 | 1.50 | 340 | 202.70 | 01421 | 5: 189.70 | 20: 183.10 |
| 4.10 | 2.00 | 340 | 110.20 | 01423 | 5: 103.10 | 20: 99.50 |
| 6.10 | 2.00 | 340 | 139.60 | 01424 | 5: 130.60 | 20: 126.10 |
| 8.10 | 2.00 | 340 | 169.00 | 01425 | 5: 158.20 | 20: 152.70 |
| 10.10 | 2.00 | 340 | 197.00 | 01426 | 5: 184.60 | 20: 178.20 |
| 12.10 | 2.00 | 340 | 225.50 | 01427 | 5: 211.00 | 20: 203.70 |
| 4.10 | 2.50 | 340 | 117.90 | 01430 | 5: 110.30 | 20: 106.40 |
| 6.10 | 2.50 | 340 | 151.20 | 01431 | 5: 141.40 | 20: 136.50 |
| 8.10 | 2.50 | 340 | 184.50 | 01432 | 5: 172.60 | 20: 166.50 |
| 10.10 | 2.50 | 340 | 216.50 | 01433 | 5: 202.50 | 20: 195.60 |
| 12.10 | 2.50 | 340 | 248.50 | 01434 | 5: 232.40 | 20: 224.40 |
| 4.10 | 3.00 | 340 | 126.40 | 01436 | 5: 118.20 | 20: 114.10 |
| 6.10 | 3.00 | 340 | 163.60 | 01437 | 5: 153.00 | 20: 147.60 |
| 8.10 | 3.00 | 340 | 200.80 | 01438 | 5: 187.90 | 20: 181.40 |
| 10.10 | 3.00 | 340 | 235.80 | 01439 | 5: 220.60 | 20: 213.00 |
| 12.10 | 3.00 | 340 | 270.80 | 01440 | 5: 253.30 | 20: 244.60 |

Short notice tailoring to site conditions possible!

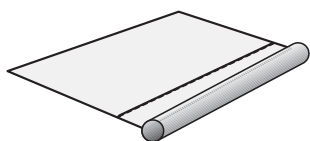

Keder tarpaulin, reinforced design, hardly inflammable

This PVC coated tarpaulin provides for water and dust-tight covering of places of work where shot blasting and corrosion protective work is carried out. The purpose is to also prevent pollution of the environment. The tarpaulin is available in all lengths (max. 20 m) and **in all random widths**. Available in white, green, blue or grey. For intermediate widths, the next larger bay dimension is used. This tarpaulin is hardly inflammable according DIN 4102 B1.

When ordering, please indicate the required colour and the individual axis dimensions of the scaffold bays.

The tarpaulin can be supplied, upon request, either with Keder border or brass eyelets on the front side to fasten it to the next tarpaulin, thus tensioning it and avoiding flatter.

Special sizes and colours upon request

Pricing example:

| Length m | Width m | Weight g/m ² | List price/m ² | Part Nr. | for order volume of: Price per piece | |
|-------------|------------|----------------------------|--|-------------|--------------------------------------|-------------------|
| 8.10 | 2.50 | 650 | 268.30 | | 5: 255.80 | 20: 237.50 |
| | | | incl. Keder border | | | |
| | | | corresponds to price of/m ² : | | 5: 12.63 | 20: 11.72 |

TARPAULINS, NETS AND KEDER SYSTEMS

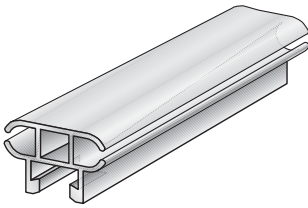

Keder holder rail

Aluminium section for attaching the border of the tarpaulin.

| Length m | Width m | Weight approx. kg | List price | Part No. | for order volume of: Price per piece | |
|-------------|------------|----------------------|---------------|-------------|--------------------------------------|------------------|
| 1.00 | | 1.50 | 14.90 | 01449 | 1: 13.40 | 20: 11.95 |
| 2.00 | | 3.00 | 29.80 | 01454 | 1: 26.80 | 20: 23.90 |
| 3.00 | | 4.50 | 44.70 | 01456 | 1: 40.20 | 20: 35.85 |
| 4.00 | | 6.00 | 59.60 | 01458 | 1: 53.60 | 20: 47.80 |
| 5.00 | | 7.50 | 74.50 | 04714 | 1: 67.00 | 20: 59.75 |
| 6.00 | | 9.00 | 89.40 | 01459 | 1: 79.90 | 20: 69.90 |



Spacing coupler

for fitting the Keder rail to the scaffolding tubes.

| | | Weight approx. kg | List price | Part No. | for order volume of: Price per piece | |
|-------|--|----------------------|---------------|-------------|--------------------------------------|------------------|
| SW 19 | | 1.20 | 16.40 | 01442 | 1: 15.40 | 50: 14.80 |
| SW 22 | | 1.20 | 16.40 | 01441 | 1: 15.40 | 50: 14.80 |



Ridge Keder holder rail

for the erection of gabled roofs

| Length m | Width m | Weight approx. kg | List price | Part No. | for order volume of: Price per piece | |
|-------------|------------|----------------------|---------------|-------------|--------------------------------------|------------------|
| 1.00 | | 1.50 | 24.80 | 01450 | 1: 23.50 | 20: 22.70 |

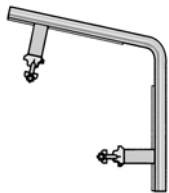

Eaves Keder holder rail

for the crossover from gable / lean-to-roofs and the scaffold wall.

| Length m | Width m | Weight approx. kg | List price | Part No. | for order volume of: Price per piece | |
|-------------|------------|----------------------|---------------|-------------|--------------------------------------|------------------|
| 1.00 | | 1.50 | 32.40 | 01451 | 1: 29.80 | 20: 26.30 |

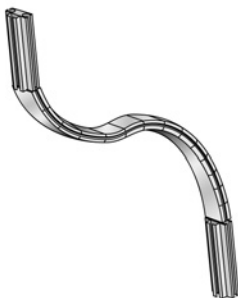

Flexible Keder holder rail

| Length m | Width m | Weight approx. kg | List price | Part No. | for order volume of: Price per piece | |
|-------------|------------|----------------------|---------------|-------------|--------------------------------------|------------------|
| 1.00 | | 1.50 | 55.60 | 01452 | 1: 52.30 | 20: 48.40 |

SHRINK FOIL



Special shrinking foil

for water, dust and wind-tight jacketing of scaffolds.
Is shrunk all-round onto the scaffolding.

Thickness: 300 µ

| Length m | Width m | Weight approx. kg | List price | Part No. | Colour | for order volume of: Price per piece | |
|-------------|------------|----------------------|---------------|-------------|--------|--|-------------------|
| 30 | 4.00 | 32.6 | 282.00 | 04965 | white | 1: 255.00 | 20: 217.50 |
| 20 | 7.00 | 38.8 | 375.00 | 04966 | white | 1: 340.00 | 20: 290.00 |
| | | | | | | corresponds to price of/m ² : | |
| | | | | | | 1: 1.70 | 20: 1.45 |

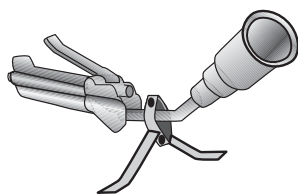

Burner complete

with pressure regulator, hose = 10 m and hose protection facility.
Special propane burner for welding and shrinking the foil.

| Length m | Width m | Weight approx. kg | List price | Part No. | for order volume of: Price per piece | |
|-------------|------------|----------------------|---------------|-------------|--------------------------------------|------------------|
| | | 0.6 | 140.60 | 04970 | 1: 130.00 | 5: 120.00 |



Holder circlip for shrinking foil

for locating the foil on the scaffold tube.

| Length m | Width m | Weight approx. kg | List price | Part No. | for order volume of: Price per piece | |
|-------------|------------|----------------------|---------------|-------------|--------------------------------------|-----------------|
| | | | 2.50 | 05051 | 1: 2.30 | 50: 1.90 |



Special gauntlets

extra long, robust leather.

| Length m | Width m | Weight approx. kg | List price | Part No. | for order volume of: Price per piece | |
|-------------|------------|----------------------|---------------|-------------|--------------------------------------|-----------------|
| | | | 5.10 | 04976 | 1: 4.60 | 20: 3.90 |



Safety harness

According to DIN-EN 361-2, breast-shoulder belt with leg belt, granting utmost safety on site.

| Length m | Width m | Weight approx. kg | List price | Part No. | for order volume of: Price per piece | | |
|-------------|------------|----------------------|---------------|-------------|--------------------------------------|-----------------|------------------|
| | | 1.0 | 56.45 | 01371 | 1: 49.00 | 5: 46.30 | 10: 44.20 |



Connecting rope

With fall damper and snap-hook with wangled nylon rope, 1,50 m long, according DIN-EN 354/355.

| Length m | Width m | Weight approx. kg | List price | Part No. | for order volume of: Price per piece | | |
|-------------|------------|----------------------|---------------|-------------|--------------------------------------|-----------------|------------------|
| 1.5 | | 0.3 | 52.36 | 01373 | 1: 45.50 | 5: 42.90 | 10: 41.30 |



Safety harness

According to DIN-EN 353-2, with flexible track, rope contractor/fall damper. Wangled 16 mm Ø nylon rope with 0.50 m long connecting rope and snap-hook.

| Length m | Width m | Weight approx. kg | List price | Part No. | for order volume of: Price per piece | | |
|-------------|------------|----------------------|---------------|-------------|--------------------------------------|------------------|-------------------|
| 10.00 | | 2.0 | 136.72 | 01375 | 1: 115.00 | 5: 110.80 | 10: 107.60 |
| 15.00 | | 3.0 | 146.43 | 01377 | 1: 125.00 | 5: 119.60 | 10: 115.30 |

SITE SAFETY EQUIPMENT

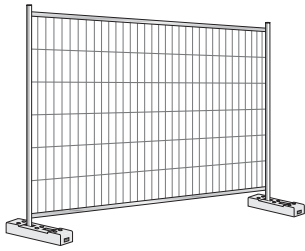

Site fence ROBUST

Steel tube frame, hot dip galvanized, 41.5 x 2.7 mm Ø with 4.0/4.6 mm Ø round wire mesh, mesh width 100 x 300 mm, non-twisting, including connections.

| Length m | Width m | Weight kg | List price | Part No. | for order volume of: Price per piece | | |
|-------------|------------|--------------|---------------|-------------|--------------------------------------|------------------|------------------|
| 3.50 | 2.00 | 22.7 | 69.60 | 00806 | 1: 65.00 | 10: 58.00 | 25: 52.50 |

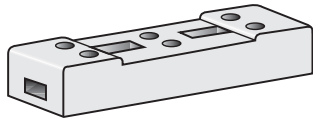

Concrete base

Made of gravel concrete with six holes and two handle holes.

| Length m | Width m | Weight kg | List price | Part No. | for order volume of: Price per piece | | |
|-------------|------------|--------------|---------------|-------------|--------------------------------------|-----------------|-----------------|
| 0.71 | 0.23 | 36.0 | 9.50 | 00808 | 1: 8.90 | 10: 7.85 | 25: 7.50 |

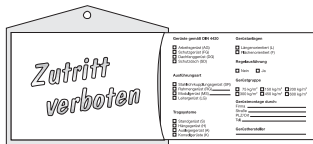

Scaffold sign

PVC, with transparent pocket for scaffold classification forms DIN A5.

| Length m | Width m | Weight kg | List price | Part No. | for order volume of: Price per piece | | |
|-------------|------------|--------------|---------------|-------------|--------------------------------------|-----------------|------------------|
| 0.21 | 0.20 | | 1.48 | 01411 | 1: 1.30 | 50: 1.09 | 100: 0.99 |

| | |
|---|--|
| Gerüste gemäß DIN 4420 <input type="checkbox"/> Arbeitsgerüst (AG) <input type="checkbox"/> Schutzgerüst (F-G) <input type="checkbox"/> Dachhanggerüst (DX) <input type="checkbox"/> Schutzdach (SD) | Gerüstanlagen <input type="checkbox"/> Längsorientiert (L) <input type="checkbox"/> Flächorientiert (F) |
| Ausführungsart <input type="checkbox"/> Stahlrohrkuppelgerüst (SR) <input type="checkbox"/> Rahmengerüst (RG) <input type="checkbox"/> Modulgerüst (MS) <input type="checkbox"/> Leihgerüst (LG) | Regelauflösung <input type="checkbox"/> Nein <input type="checkbox"/> Ja |
| Tragsysteme <input type="checkbox"/> Ständergerüst (S) <input type="checkbox"/> Hängergerüst (H) <input type="checkbox"/> Auslegergerüst (A) <input type="checkbox"/> Konsolgerüst (K) | Gerüstgruppe <input type="checkbox"/> 75 kg/m ² <input type="checkbox"/> 150 kg/m ² <input type="checkbox"/> 200 kg/m ² <input type="checkbox"/> 300 kg/m ² <input type="checkbox"/> 450 kg/m ² <input type="checkbox"/> 600 kg/m ² |
| Gerüstmontage durch: Firma _____ Straße _____ PLZ/Ort _____ Tel. _____ Gerüsthersteller _____ | |

Form block

for attaching to the signs. 50 sheets, DIN A5, per block for classifying the scaffold on site.

| Length m | Width m | Weight kg | List price | Part No. | for order volume of: Price per piece | | |
|-------------|------------|--------------|---------------|-------------|--------------------------------------|-----------------|-----------------|
| | | | 2.25 | 01412 | 1: 2.10 | 10: 1.99 | 25: 1.76 |

CONDITIONS OF SALE AND DELIVERY

Conditions of sale and delivery of RUX GmbH, Neue Straße 7, DE-58135 Hagen

1. Conclusion of contract

- 1.1 These general conditions of sale and delivery apply to all present and future contracts provided they are not amended or excluded without our express written agreement. Conditions of the purchaser are not binding even when, after receipt of the contract, we do not expressly reject such conditions.
- 1.2 Our quotations are submitted without obligation. Contract conclusions and other agreements, in particular all subsidiary agreements and assurances made by our sales representatives, are only binding upon receipt of our written confirmation.

2. Prices

- 2.1 The prices provide for delivery ex works or depot plus freight, packing and value added tax (domestic business only) at the rates prevailing.
- 2.2 In the event that our cost prices increase for reasons beyond our control (e.g. new regulations imposed by the authorities) or such items as freight, taxes or fees are introduced or increased after conclusion of the contract, we are entitled to amend our prices accordingly. In the case of an incommensurate price increase, the purchaser has the right to withdraw from the contract. A price increase amounting to 20% of the agreed purchase price or less, not including value added tax, is deemed to be reasonable. A lump sum administration fee of EUROS 20,00 will be charged on sales below our minimum order value of EUROS 50,00.

3. Payment

- 3.1 Payment of the purchase price shall be made within the agreed period in cash, without deduction, or by remittance to our account, irrespective of the receipt of the goods and without prejudice to the right of claim, and excluding set-off against disputed or not legally binding accounts receivable. Withholding of payments is illegal. If the purchaser is a non-trader, then he is entitled to withhold payment to the extent that such entitlement is based on the same contractual relationship.
- 3.2 In the event of delayed payment by the purchaser, we are entitled to charge interest in accordance with the rate of our house bank for overdraft facilities, at least, however, interest at 8% above the basic interest rate of the Federal German Bank, plus value added tax. We reserve the right to claim for any additional contractual losses.
- 3.3 All receivables become due immediately, irrespective of the due date of received and credited bills, when the purchaser delays remittance of a due payment to us for longer than 10 days. The same applies when the purchaser files a petition in bankruptcy or becomes distressed. We are also entitled to supply outstanding consignments on cash-in-advance terms only and withdraw from the contract after a reasonable period of time or demand damages for non-fulfilment. We have the right to prohibit the resale of the goods, demand their return or transfer of constructive possession, at the cost of the purchaser, and also revoke the authorization to collect as per § 6.4. We are entitled, in the aforementioned cases to set foot on the premises of the purchaser, seize the goods, sell them privately at the best possible price and set off the amount against the unsettled purchase price receivables, less costs incurred.
- 3.4 In the case of seizure of material by us, we are entitled to take over goods at the market value. The purchaser pledges to assign his title of the goods to us.

4. Delivery period, delivery dates

- 4.1 The delivery date is not binding. Delay in delivery is deemed to exist when the agreed delivery date is exceeded intentionally or in a grossly negligent manner by more than 2 months.
- 4.2 If we are late in delivering, the purchaser is entitled to set a reasonable time extension in writing. After expiry of the time extension, the purchaser is entitled to withdraw from the contract, but only to the extent that deliveries have not been expedited within the extension period. Claims for damages by reason of slight negligence are excluded.

5. Act of God and other hindrances act preventing delivery

We are entitled, in the event of acts of God, to defer delivery for the duration of the disruption and a reasonable restart period or to withdraw partly or completely from the contract for the part which has not been fulfilled. Acts of God are deemed as being labour disputes, mobilization, war, blockade, import and export embargos, shortages of raw materials and fuels, fire, transportation blockages, factory or transport disturbances and other circumstances beyond our control irrespective of whether they occur at our premises or at those of subcontractors.

6. Retention of title

- 6.1 All goods supplied remain our property (goods subject to retention of title) until such time as all accounts have been settled, notwithstanding legal considerations and including future or contingent receivables resulting from contracts concluded at the same time or contracts concluded at a later date. This also applies to payments made against specifically designated accounts receivable. In the event that the amount of the assigned receivables and/or the goods subject to retention of title considerably exceed the remaining outstanding amount, we are obliged, at the request of the purchaser, to relinquish a part of the retention of title and/or release a part of the assigned receivables emanating from a resale. Considerable is deemed to be a difference between outstanding amount and security of more than 20%. In this case, the purchaser is obliged to mark the scaffolding material in his possession such that the material which is still our property can, if necessary, be identified without doubt. In the event that an assignment of accounts receivable is relinquished, the purchaser is obliged to disclose beforehand all receivables resulting from the sale of scaffolding material.
- 6.2 The purchaser may sell the goods subject to retention of title only within the framework of normal business and in accordance with normal terms of sale, and as long as he is not in default, provided the accounts receivable resulting from the resale as per § 3 to 5 are passed on to us. The purchaser is not entitled to dispose of the goods subject to retention of title in any other manner.
- 6.3 The purchaser's accounts receivable resulting from resale of the goods subject to retention of title are now already assigned to us. They serve as surety to the same extent as the goods subject to retention of title themselves. In the event that the goods are resold by the purchaser together with other goods not sold by us, then the assignment of the accounts receivable resulting from the resale only applies to the value of the goods sold.
- 6.4 The purchaser is entitled to collect receivables resulting from the resale until such time as we revoke the contract. We shall only exercise our right to revoke in the three cases mentioned in § 3. The purchaser is only entitled to assign accounts receivable after having previously received our express written consent. The purchaser is obliged, upon our demand, to advise his clients of the assignment to us immediately - unless we do not do this ourselves - and provide us with the necessary credit information and documents for collection.
- 6.5 In the event that we exercise our right of retention of title, this shall only be deemed to be a withdrawal from the contract when we expressly declare same in writing. The right of ownership of the purchaser to the goods subject to retention of title ceases to exist when his obligations in respect of this or another contract are not fulfilled.
- 6.6 All rights resulting from the retention of title, and the special forms thereof laid down in these conditions of sale and delivery, shall remain in force up to the time of complete release, also from eventual liabilities into which we have entered in the interest of the purchaser.

7. Despatch, passing of risk, partial deliveries, continuous deliveries

- 7.1 Provided, no other agreement has been made in writing, we determine route and means of despatch, as well as the forwarder and carrier.
- 7.2 Goods ready for shipment must be called off immediately, otherwise we are entitled to either despatch them at the risk, and cost, of the purchaser or to store at our discretion and invoice immediately in accordance with the terms of payment agreed for the transaction.
- 7.3 The goods are normally delivered unpacked and not protected against rust. On material which is packed, the purchaser is obliged to unpack and dispose of the packing material at his cost.
- 7.4 The risk is passed on all transactions, including that of confiscation, to the purchaser when the goods are handed over to a forwarding agent or carrier at the latest, however, on leaving the warehouse or the supplying factory.
- 7.5 In the event of defects on goods supplied, such goods shall still be accepted by the purchaser without prejudice to any eventual rights, provided we have not caused such defects through gross negligence.
- 7.6 Insurance cover is only taken out at the request of and for account of the purchaser.

8. Notification of defects and warranty

We are liable for defects and defective title as follows:

- 8.1 The point of time at which the risk passed to the purchaser is decisive for the contractual condition of the goods.
- 8.2 The purchaser is obliged to thoroughly inspect the goods immediately upon receipt using the facilities he has available. The purchaser shall notify the vendor in writing of any defects established.
- 8.3 In the event of justified claims for defects, the vendor shall take back the defective goods and replace them with goods of perfect condition, otherwise we are entitled to refund the undervalue or refurbish the goods thereby reasonably safeguarding the interests of the purchaser.
- 8.4 If we do not fulfil our obligations to refurbish or supply replacements within the set time limit or in accordance with the contract, the purchaser is entitled to cancel the contract or reduce the purchase price of the goods.
- 8.5 If the purchaser does not immediately give us the opportunity of inspecting the goods or does not put samples of the faulty goods immediately at our disposals upon request, then all claims for warranty will be automatically forfeited.
- 8.6 The right of the purchaser to enforce claims for warranty expires one month after written rejection of the notification of defects by the vendor, at the latest 12 months from the date of delivery.

9. Limitation of liability

- 9.1 Claims not expressly conceded in these conditions of sale and delivery, in particular claims for damages resulting from breach of duty, impossibility, default, violation of contractual secondary obligations, wrongful act - also as far as such claims are tied up with the warrantyrights of the purchaser - are excluded unless we are pre-emptorily liable in case of gross negligence or malice. Liability for consequential damages as a result of defects is excluded to the extent that such liability is not included in the statutory provisions of product liability.
- 9.2 All claims which are not warranty claims for defective goods expire, irrespective of legal considerations, at the latest 1 year after the passing of risk to the purchaser if the statutory limitation period is not shorter.
- 9.3 Liability of any kind on our part for damages and consequential damages is excluded if the delivered goods are stored and processed or used competently and appropriately. This does not apply when the buyer furnishes proof that a damage is not due to incompetent and inappropriate storage, processing or use. Part of the competent and appropriate storage for wooden materials is e.g. their ventilation. A competent and appropriate handling of the goods during the erection and disassembly of scaffolds requires the observation of all prescribed regulations of technology, including the DIN standards and maintaining all qualification requirements and static standards.

10. Place of performance, place of jurisdiction and law applicable.

- 10.1 Place of performance for our ex-works deliveries is the supplying factory, otherwise for all other deliveries our depot. Place of jurisdiction is Hagen.
- 10.2 Should the purchaser infringe any of the laws on turnover tax, in particular in respect of information on the turnover tax ID number, the purchaser is obliged to compensate us for any loss we may incur as a result. We reserve the right of assertion of claims for additional damage.
- 10.3 Should a part of these conditions of sale and delivery prove to be inoperative or void, the effectiveness of the remaining conditions will not be affected. In such case, and as far as legally possible and admissible, the non-operative or void clause is to be replaced or supplemented in such a manner that the intended purpose of the non-operative clause, namely to safeguard commercial interests, is achieved.



SUPER FACADE SCAFFOLD

VARIANT MODULAR SCAFFOLD

RINGSCAFF MODULAR SCAFFOLD

NON-SYSTEM ACCESSORIES

WEATHER PROTECTION SYSTEM

HEAVY DUTY PROP SYSTEM

MOBILE SCAFFOLDING

LIFTS

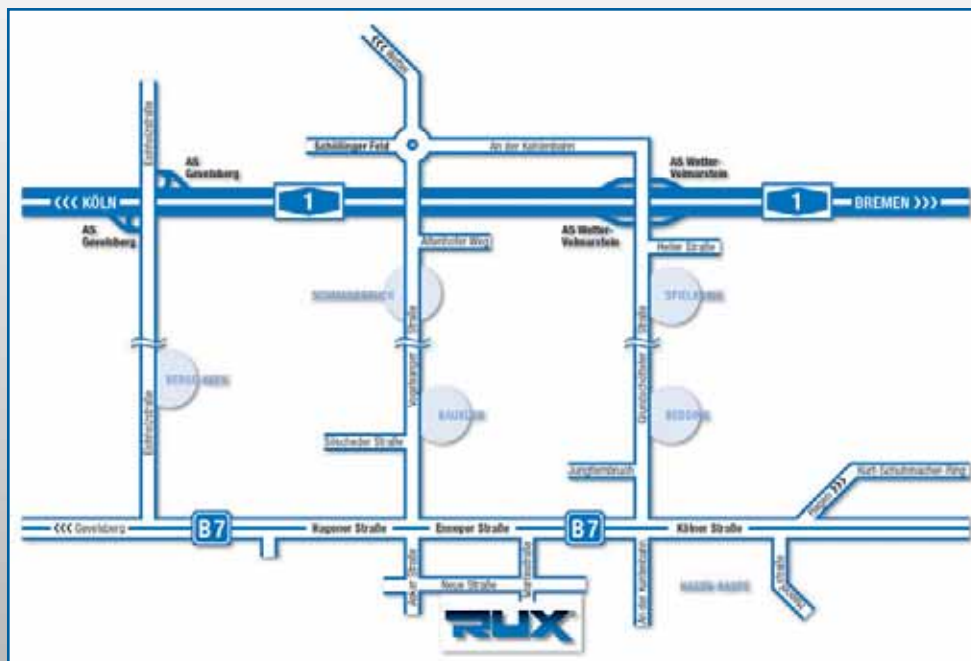

RUX GmbH
Neue Straße 7
D-58135 Hagen

Phone +49 2331 4709-0
Fax +49 2331 4709-202
www.rux.de · info@rux.de

Hotline
+49 2331 4709-180